

MODEL 150-DC



24100 Series Double Check Backflow Preventer 3/4" to 2"

APPLICATION AND DESCRIPTION

The 24100 Series Double Check device prevents backflow of water in low hazard applications. It consists of two independently operating check valves with shutoff valves and test cocks. They protect against back-siphonage and backpressure. Used in irrigation systems, fire protection systems, industrial plant protection, and other non-toxic applications.

FEATURES AND BENEFITS

- Certification by USC Foundation for Cross Connection Control and Hydraulic Research, ASSE, AWWA, IAPMO, and City of New York.
- Optional replaceable brass valve seats for improved serviceability.
- Spring loaded Y check valves reduce friction loss.
- All internal parts are easily serviceable without removing the valve body.
- Available with or without resilient seated ball valves.
- Operates when installed in any position.
- Pressure rated to 175 psi and hydrostatically tested to 350 psi.
- Temperature rated to 180 degrees F.
- Corrosion resistant internal parts.
- All test cocks are blowout resistant.

OPTIONS

- Without ball valves -NBV (/60)
- BSPT without ball valves -BSPT-NBV (/55)
- Replaceable brass seats -RS (/25)

PERFORMANCE

CAT. NO.	MODEL NO.	SIZE NPT	FLOW IN GPM														
			5	10	15	20	30	40	50	60	70	80	100	120	150	170	200
24100	075-DC	3/4"	4.0	4.1	4.2	4.6	6.1	--	--	--	--	--	--	--	--	--	--
24101	100-DC	1"	--	4.0	4.1	4.1	4.3	5.0	6.8	9.9	--	--	--	--	--	--	--
24102	125-DC	1 1/4"	--	--	4.0	4.0	4.1	4.6	5.3	6.8	8.9	--	--	--	--	--	--
24103	150-DC	1 1/2"	--	--	--	4.0	4.0	4.1	4.2	4.3	4.5	4.8	4.8	5.1	--	--	--
24104	200-DC	2"	--	--	--	--	--	3.5	3.5	3.5	3.5	3.5	3.7	4.4	6.6	7.8	11.8

MODEL DESCRIPTIONS

MODEL NO.	SIZE NPT	DIMENSIONS - inches		
		Height	Width	Length
075-DC	3/4"	7 3/8"	4"	12 1/4"
100-DC	1"	7 3/8"	4"	12 1/4"
125-DC	1 1/4"	9 1/4"	5 1/2"	17 1/4"
150-DC	1 1/2"	9 1/4"	5 1/2"	17 1/4"
200-DC	2"	9 1/4"	5 1/2"	18 1/2"



HOW TO SPECIFY

1 2 5 - D C - R S

↑ ↑ ↑

SIZE TYPE OPTION

This specifies a 1 1/4" double check backflow preventer with replaceable seats.

MATERIALS

Body: cast brass
 Internal assemblies: engineered polymer check valves
 Guides: engineered polymer
 Springs: stainless steel
 Rubber seats: Buna-A or EPDM

INSTALLATION

Assembly must be installed where accessible for testing and maintenance. Flush pipeline thoroughly before installation. Assembly should be installed 12" above grade (30" max). Consult local codes for installation requirements. When threading the device onto the line, place wrench only on the ball valve hex ends. After install, open the inlet ball valve to fill device. Bleed air from unit via the test cocks. If check valve fails to hold 1 PSI, close ball valves, bleed test cocks, remove check valve bonnet and check the seat and/or seat disc for fouling. Device must be protected from freezing.

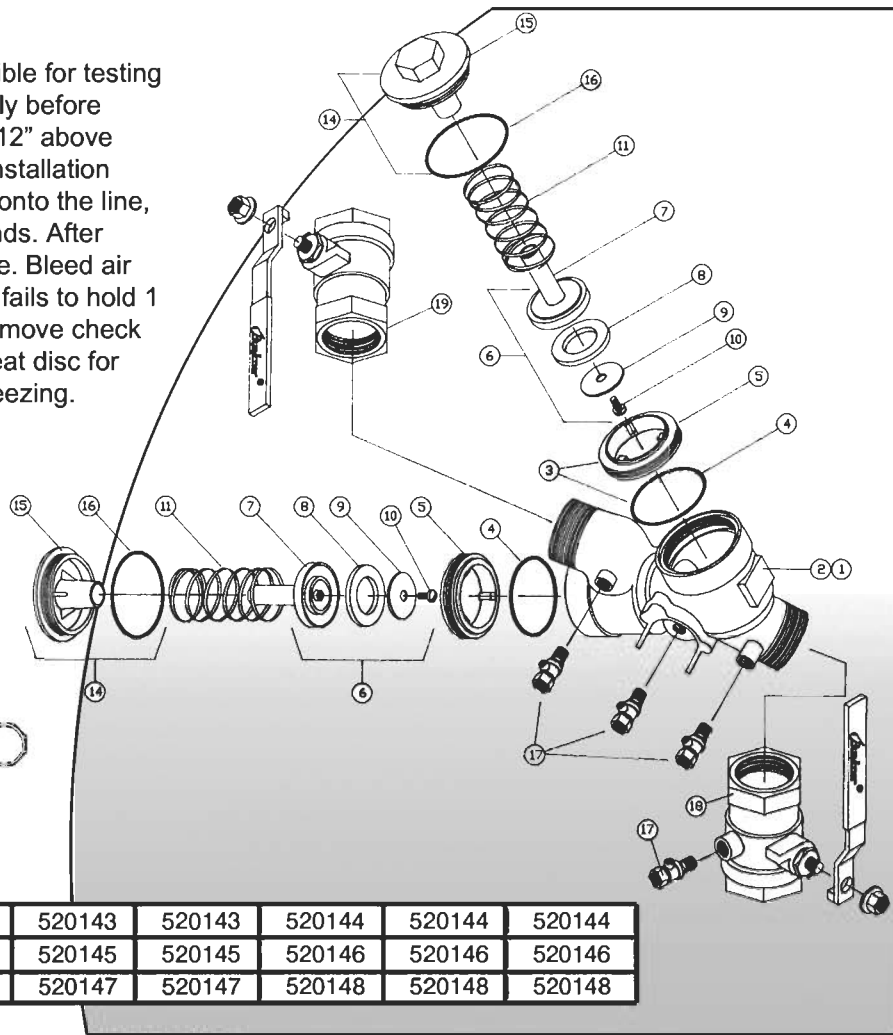

SERVICE KITS

Check Valve Rubber Kit (#8 & 16, 2 of each)	520143	520143	520144	520144	520144
Check Valve Kit (#6 & 16)	520145	520145	520146	520146	520146
Ring Seal Kit (#4 & 5)	520147	520147	520148	520148	520148

Commercially Available Parts for Series 24000 Valves

ITEM	DESCRIPTION	MATERIAL	3/4"	1"	1 1/4"	1 1/2"	2"
4	O-Ring	BUNA-N	AS568-127	AS568-127	AS568-144	AS568-144	AS568-144
10	Screw	St. Steel	1/4-20 x 3/8" Truss Head	1/4-20 x 3/8" Truss Head	1/4-20 x 3/8" Truss Head	1/4-20 x 3/8" Truss Head	1/4-20 x 3/8" Truss Head
16	O-Ring	BUNA-N	AS568-226	AS568-226	AS568-236	AS568-236	AS568-236

NOTE: The above listed parts in addition to non-listed items such as ball valves, test cocks, flange gaskets, etc. are commercially available through most hardware distributors or retailers.

Parts Listing

ITEM	DESCRIPTION	QTY.	3/4" 24100	1" 24101	1 1/4" 24102	1 1/2" 24103	2" 24104
1	Body Assembly, Check Valve - Includes:	1	—	—	—	—	—
2	Body	1	501553	501554	501555	501556	501557
3	Replaceable Ring Seal*	2	—	—	—	—	—
4	Seal, O-ring	1	—	—	—	—	—
5	Seat, Replaceable	1	—	—	—	—	—
6	Poppet Seat Assembly - Includes:	2	—	—	—	—	—
7	Poppet	1	—	—	—	—	—
8	Seat Disc	1	—	—	—	—	—
9	Washer	1	—	—	—	—	—
10	Screw	1	—	—	—	—	—
11	Spring	2	501448	501448	501436	501436	501436
14	Bonnet Assembly - Incl.	2	510725	510725	510685	510685	510685
15	Bonnet	2	—	—	—	—	—
16	Seal, O-ring	2	—	—	—	—	—
17	Test Cock	4	611901	611901	611900	611900	611900
18	Valve Assembly, Ball Upstream	1	510648	510726	510755	510757	510759
19	Valve Assembly, Ball Downstream (Whole Goods)	1	22080	22081	22082	22083	22084

American Backflow Specialties

www.americanbackflow.com

(800) 66-BKFLO

(619) 527-2525

Fax: (619) 527-2527