

SERIES 40-100 Top Entry Double Check Valve Assembly 3/4" to 2"

FEATURES

- Top access for testing, repair and maintenance
- Corrosion resistant
- Low head loss
- Interchangeable poppets and springs
- Replaceable seats
- Comes standard with Apollo® full port ball valves with stainless steel handles
- Maximum working pressure 175 psi
- Temperature range 33°F-180°F

DESCRIPTION

Series 40-100 Top Entry Double Check Valve is designed to control cross connections between potable water lines and substances that are objectionable, but are not a health hazard. It is a compact, economical device that is easily repaired in-line.

The device consists of two independent spring loaded poppet check valves in a single bronze body. Both check valves are designed at an inclined angle upward from horizontal center-line of the assembly, and all test cocks are mounted at the top to assure easy access during repair and maintenance when unit is installed in a pit or tight places.

APPROVALS

ASSE 1015, AWWA C-510,
CSA B64.5, USC FCCC & HR

OPERATION

During normal flow conditions, the two check valves are held off their seats, supplying water downstream. Each check valve is designed to maintain a minimum of 1 psi across the valve during normal operation. Should the downstream pressure increase to within 1 psi of supply pressure, both check valves will close to prevent a backflow condition.

MATERIALS

Body and covers	Bronze
Springs	Stainless Steel
Poppets	Glass-Filled Celcon
Seat discs	Silicone Rubber
Replaceable seat	Glass-Filled Noryl
Fasteners	Stainless Steel



MODELS

40 - 1 X X - TX

Y-STRAINER	SIZE	NON UL CLASSIFIED
0-Standard	4-3/4"	1-less ball valves
1-w/ Y-strainer (shipped loose)	5-1"	2-w/ball valves
	6-1-1/4"	4-w/union end ball valves
	7-1-1/2"	
	8-2"	
		FOR UL CLASSIFIED
		FP1-less ball valves
		FP2-w/ball valves

FLOW CURVES

40-100 Top Entry Models 3/4" to 2"

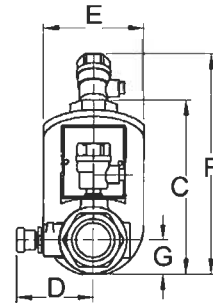
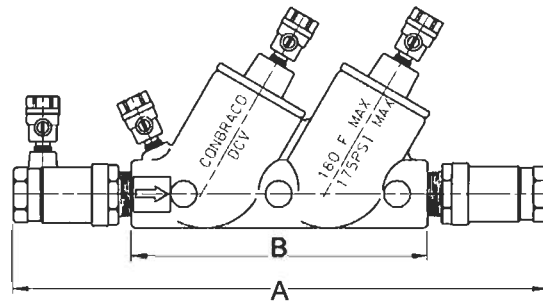
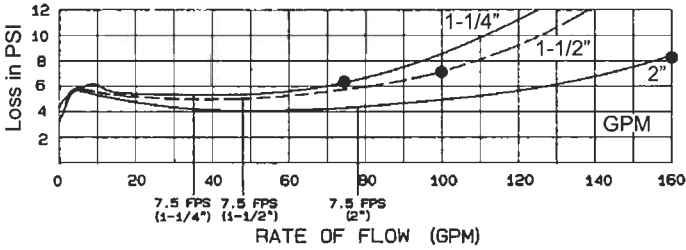
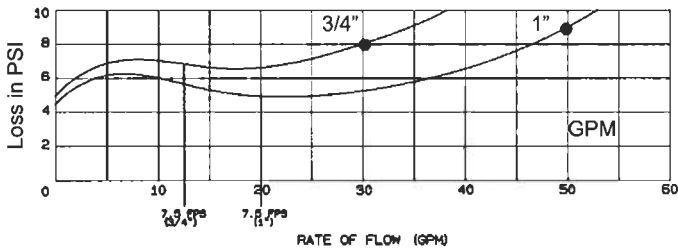

Dimensions (in) – Weights (lbs.)					
Body Size	3/4"	1"	1-1/4"	1-1/2"	2"
A	14-1/4	14-3/4	20-3/4	21-3/8	23-1/8
B	7-1/4	7-1/4	12-3/8	12-3/8	12-3/8
C	4-5/16	4-5/16	6-1/8	6-1/8	6-1/8
D	1-5/8	1-7/8	2-3/16	2-5/8	3
E	2-7/16	2-7/16	3-13/16	3-13/16	3-13/16
F	5-7/16	5-7/16	6-3/8	6-3/8	6-3/8
G	13/16	13/16	1-3/8	1-3/8	1-3/8
Test Cocks	1/8 x 1/4 NPT	1/8 x 1/4 NPT	1/4 x 1/4 NPT	1/4 x 1/4 NPT	1/4 x 1/4 NPT
Net Weight	8.8	9.5	23.2	25.7	31.5
Shipping Weight	10.1	10.8	25.9	28.8	35.5

REPAIR KITS

ITEM NO.	DESCRIPTION	QUANTITY	PART NO.	
			3/4" & 1"	1-1/4", 1-1/2", 2"
Repair Kits				
<u>Major Repair Kit</u>				
(4 (2), 5 (2), 6 (2), 7 (2), 8 (2), 10 (2), 11 (2))			40-004-A5	40-007-A5
<u>Check Valve Repair Kit</u>				
(4, 5, 6, 7, 8, 10, 11)			40-004-A2	40-007-A2
<u>Rubber Repair Kit</u>				
(5 (2), 8 (2), 11 (2))			40-004-A6	40-007-A6
<u>Replaceable Seat Kit</u>				
(10 (2), 11 (2))			40-004-A8	40-007-A8

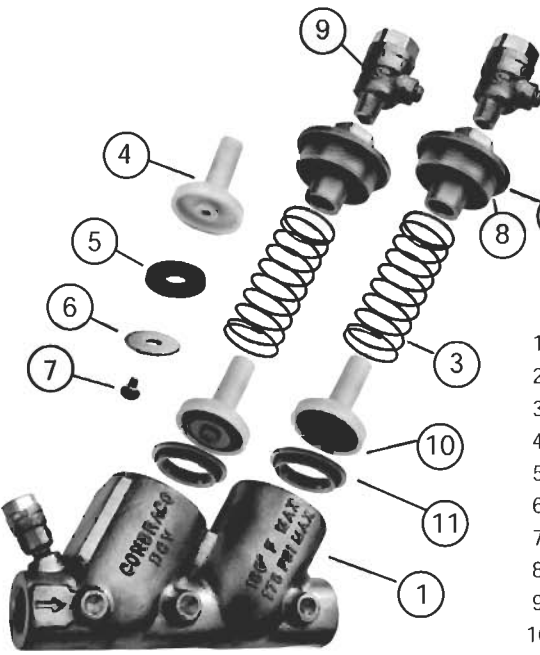

Parts				
1	Body	1	Call	Call
2	Cap	2	F-3108-00	F-3115-05
3	Spring	2	A-1700-00	A-1701-00
4	Poppet	2	K-3362-00	K-3367-00
5	Seat Disc	2	D-2503-00	D-2508-00
6	Seat Retainer	2	D-2499-00	D-2509-00
7	Screw	2	B-1750-00	B-1750-00
8	Cap O-Ring	2	D-2500-00	D-2501-00
9	Test Cock	3	78-257-01	78-258-01
10	Check Seat	2	L-4864-00	L-4866-00
11	Check O-Ring	2	D-2274-00	D-2565-00