

FEATURES

- Corrosion resistant
- Durable
- Economical
- Low head loss
- Designed for easy maintenance
- Comes standard "Apollo" shut-off valves
- Maximum working pressure 150 psi
- Operating temperature range 33°F-210°F

DESCRIPTION

Series 40-500 Pressure Type Vacuum Breaker is designed prevent backsiphonage of contaminated water into a safe drinking water supply. Ideal installation is in a continuous pressure potable system 12" above the overflow level of the system being supplied.

The device consists of a spring loaded float disc and an independently acting check valve in a corrossions resistant material.

APPROVALS

ASSE 1020, CSA B64.1.2, USC FCCC & HR



SERIES 40-500 Pressure Vacuum Breaker 1/2" to 2"

OPERATION

During normal flow conditions, the check valve remains open and the float disc seals the air inlet preventing leakage. When the internal pressure of the device falls to 1 psi or below, the spring-loaded float disc opens the air inlet and the check valve closes the water inlet. This prevents backsiphonage and creation of a vacuum at the discharge line.

MODELS

1/2"	40-503
3/4"	40-504
1"	40-505
1-1/4"	40-506
1-1/2"	40-507
2"	40-508



OPTIONS

Suffix #s

-01	Less ball valves
-02	With ball valves
-04	With union end ball valves

MATERIALS

Body	Bronze
Springs	Stainless steel
Seat discs	Silicone rubber
Valve canopy	Chrome plated brass
Fasteners	Stainless Steel
Float	Polythylene

FLOW CURVES

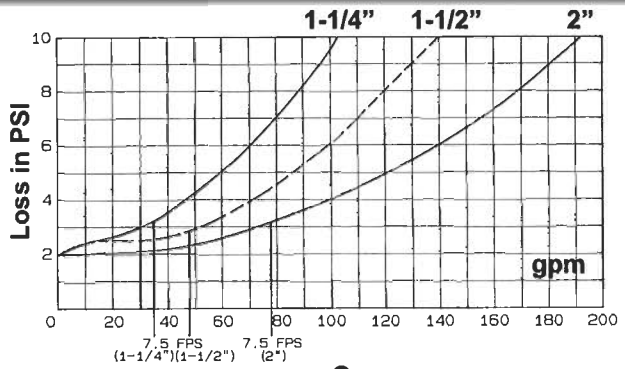
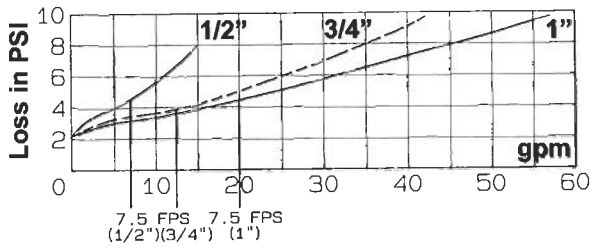

DIMENSIONS & WEIGHTS

Body Size	1/2"	3/4"	1"	1-1/4"	1-1/2"	2"
A	3-7/8	3-7/8	3-7/8	6-5/8	6-5/8	6-5/8
B (Less Ball Valves)	5-7/8	5-7/8	5-7/8	8-3/4	8-3/4	8-3/4
C	8-1/4	8-1/2	9-1/8	11-7/8	12-1/8	13
D	8-1/8	8-3/8	9	12-1/8	12-13/16	13-7/8
E	3-7/8	4-1/8	4-3/4	6-1/8	6-7/8	7-15/16
F (Less Ball Valves)	5-7/8	5-7/8	5-7/8	9-1/4	9-1/4	9-1/4
Test Cocks	1/8x1/4 NPT	1/8x1/4 NPT	1/8x1/4 NPT	1/4x1/4 NPT	1/4x1/4 NPT	1/4x1/4 NPT
Net Wt. (less ball valves)	4.0	4.25	4.5	14.0	14.1	14.2
Net Wt. (with ball valves)	5.5	6.25	7.0	20.5	22.3	28.3
Shpg. Wt.(less ball valves)	5.0	5.25	5.5	15.2	15.6	15.7
Shpg. Wt. (w/ball valves)	6.5	7.25	8.0	21.7	23.8	29.8

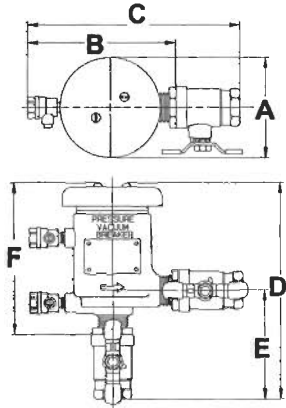

REPAIR PARTS PVB 40-500

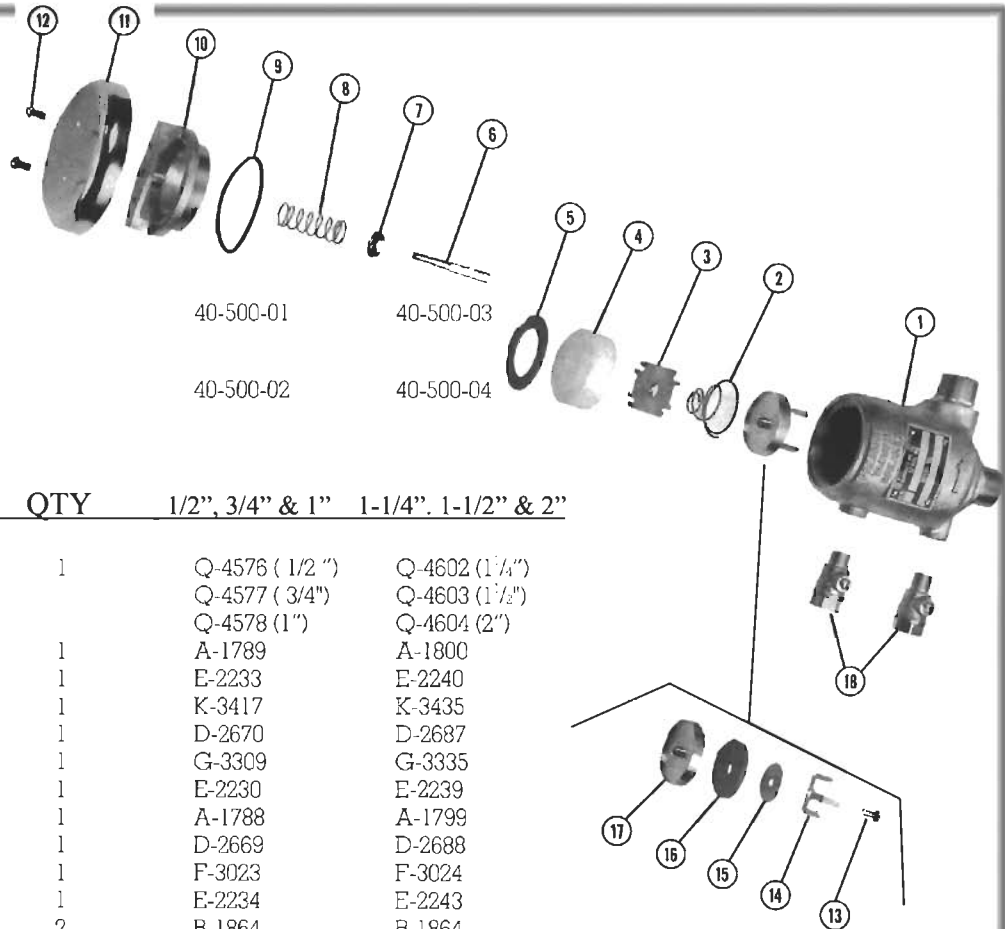

Repair Kits

RUBBER REPAIR KIT
5, 9, 16

40-500-01

40-500-03

COMPLETE REPAIR KIT
2, 4, 5, 6, 8, 9, 13, 14
15, 16, 17

40-500-02

40-500-04

Item	Description	QTY	1/2", 3/4" & 1"	1-1/4", 1-1/2" & 2"
1	BODY	1	Q-4576 (1/2 ") Q-4577 (3/4") Q-4578 (1")	Q-4602 (1 1/4") Q-4603 (1 1/2") Q-4604 (2")
2	CHECK SPRING	1	A-1789	A-1800
3	SPRING RETAINER	1	E-2233	E-2240
4	FLOAT	1	K-3417	K-3435
5	FLOAT DISC	1	D-2670	D-2687
6	GUIDE STEM	1	G-3309	G-3335
7	SPRING WASHER	1	E-2230	E-2239
8	FLOAT SPRING	1	A-1788	A-1799
9	CAP O-RING	1	D-2669	D-2688
10	CAP	1	F-3023	F-3024
11	INLET CANOPY	1	E-2234	E-2243
12	SCREW	2	B-1864	B-1864
13	SCREW	1	B-1864	B-1878
14	CHECK GUIDE	1	E-2232	E-2242
15	WASHER	1	E-2231	N/A
16	SEAT DISC	1	D-2671	D-2689
17	SEAT HOLDER	1	K-3418	K-3436
18	TEST COCK	2	78-257-01	78-258-01

**American Backflow
Specialties**
www.americanbackflow.com
(800) 66-BKFO