

Model 745 (3/4"-1") Engineered Plastic Pressure Vacuum Breaker Assembly

FEATURES

- Glass fiber reinforced nylon body and bonnet resist chemical attack and scale buildup.
- Simple line service procedures. All internal parts serviceable in-line.
- Low head loss.
One check valve and air opening in one assembly.
- Lightweight poppet seals air inlet under minimum flow conditions.
- Can be installed for continuous operation.

SPECIFICATIONS

The Febco 745 PVB was designed to be installed for protection against backsiphonage of toxic or non-toxic liquids. It consists of a spring loaded check valve which closes tightly when the pressure in the device drops below 1 PSI or when zero flow occurs, plus, an air inlet port that opens to a siphon when the pressure in the device drops to 1 PSI. There are two threaded ball valves and two test cocks. Install where it is possible to isolate an entire non-potable line from the potable system. Not to be installed where backpressure may occur.

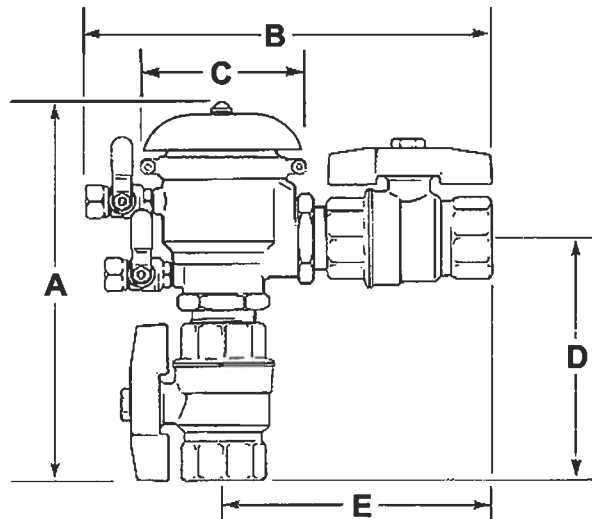

APPLICATIONS

PVB assemblies are used to protect against toxic and non-toxic backsiphonage conditions in industrial plants (in-plant applications, cooling towers, laboratories, laundries, swimming pools and lawn sprinkler systems).

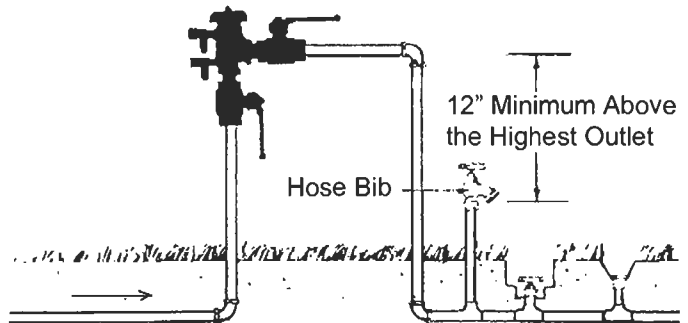

INSTALLATION



PVB Assemblies should be installed at least 12" above the highest piping or outlet downstream of the device and in a manner to preclude backpressure. They should be installed so they are easily accessible for maintenance, periodic testing, and where discharge will not be objectionable. They should be protected from freezing. They must not be installed where backpressure could occur. Thermal water expansion and/or water hammer can cause excessive backpressures. This situation should be eliminated to avoid possible damage to the system and device.

The discharge pressure must be maintained above 4.0 PSI to insure seating of the spring loaded air inlet poppet.

SIZE	A	B	C	D	E	LBS.
3/4"	7-5/8"	4-3/8"	4-3/8"	3-1/4"	3-1/8"	2-1/2
1"	7-7/8"	4-5/8"	4-5/8"	3-1/4"	3-1/8"	3

MODEL 745

FLOW CURVES

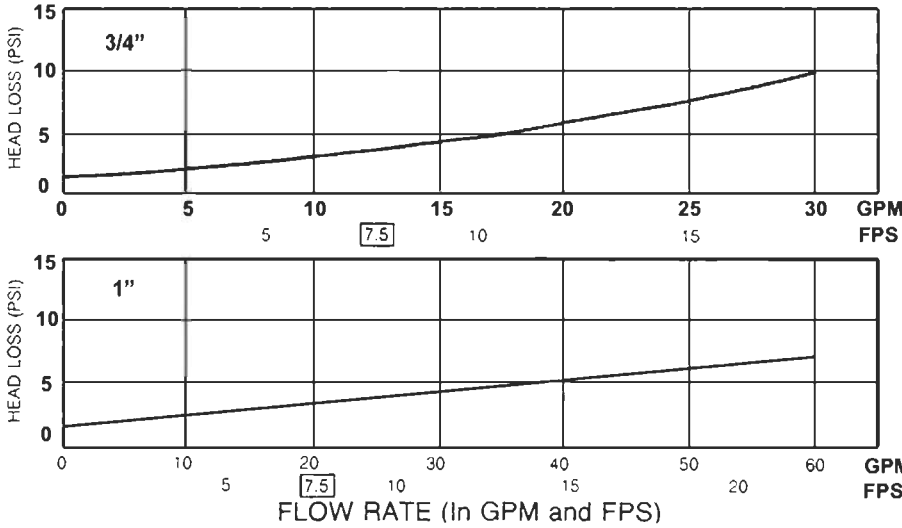

PARTS

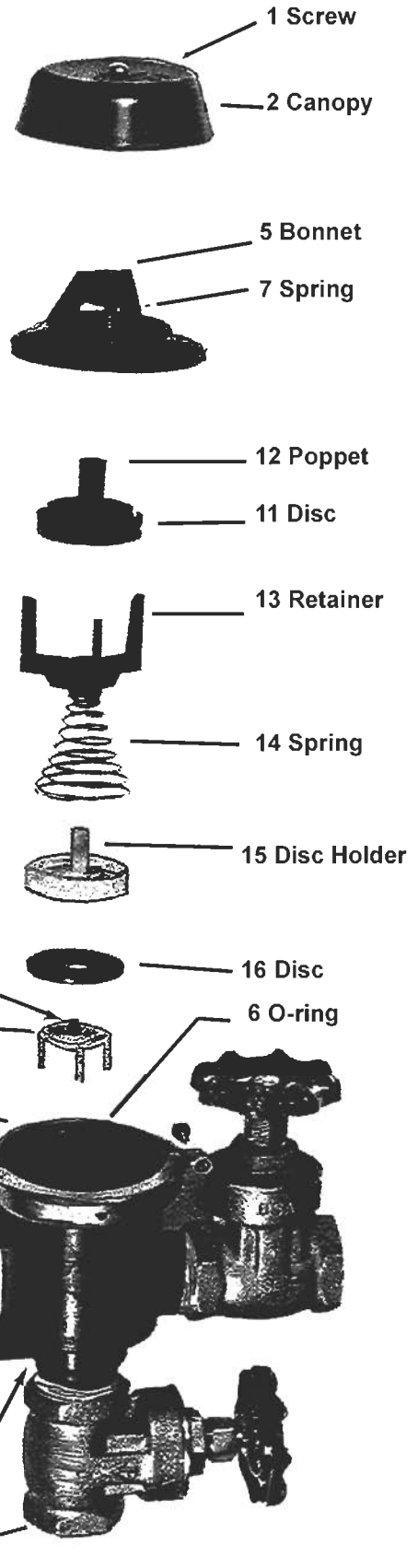

MATERIALS & CHARACTERISTICS

Maximum working pressure	150 PSI
Hydrostatic test pressure	300 PSI
Temperature range	32°F to 110°F
Fluid	Water
End detail	3/4" & 1" Threaded ANSI B2.1
Main valve body	Nylon, glass fiber reinforced (Tensile Strength 20,000 PSI)
Elastomers	Nitrile ASTM D-2000
Springs	Stainless Steel, 300 Series

American Backflow Specialties

www.americanbackflow.com

(800) 66-BKFLO

(619) 527-2525

Fax: (619) 527-2527