

## Model 765 (1/2"-2") Pressure Vacuum Breaker Assembly for High Hazard Service

### FEATURES

- All bronze body for durability. One check valve and an air opening port in one assembly.
- Lightweight poppet seals air opening under minimum flow conditions.
- Simple service procedures. All internal parts serviceable in line from the top of the unit.
- Designed for minimum head loss.
- Engineered plastic bonnet protect valve bodies from freeze damage.
- Optional union end ball valves for easy removal and ultimate freeze protection.

### INSTALLATION

Pressure Vacuum Breaker assemblies should be installed at least 12" above the highest piping and outlet downstream of the assembly to preclude backpressure. Assemblies should be installed so they are easily accessible for maintenance, periodic testing, and where discharge will not be objectionable. Assemblies must not be installed where backpressure could occur.

The discharge pressure shall be maintained above 3.0 PSI on 1/2" through 1 1/4" sizes and 5.0 PSI on 1 1/2" and 2" sizes to insure seating of the spring loaded air inlet poppet.

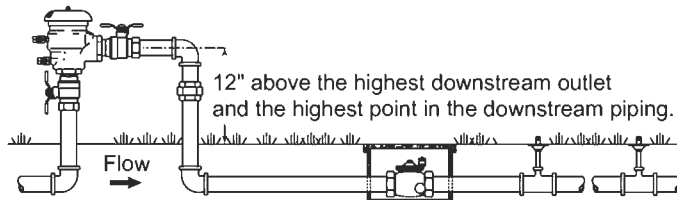

### SPECIFICATIONS

Pressure Vacuum Breaker assemblies shall be installed to withstand pressure for long periods and to prevent backflow of contaminated water into the potable water system in backsiphonage conditions. The Pressure Vacuum Breaker assembly shall consist of a single spring loaded check valve which closes tightly when water flow through the assembly drops to zero, and a single air relief valve that opens to break the siphon when pressure drops to 1 PSI. The assembly shall include two resilient seated shut-offs and two resilient seated test cocks, considered integral to the assembly. Assemblies must be factory backflow tested. The check valve and air inlet valve must be constructed to allow in-line servicing of the assembly. The valve body shall be constructed of bronze. The check, poppet and bonnet assembly shall be constructed of engineered plastic to protect the valve body from freeze damage.

### APPLICATIONS

PVB assemblies are used to protect against health hazard and non-health hazard backsiphonage conditions in industrial plants, cooling towers, laboratories, laundries, swimming pools and lawn sprinkler systems.

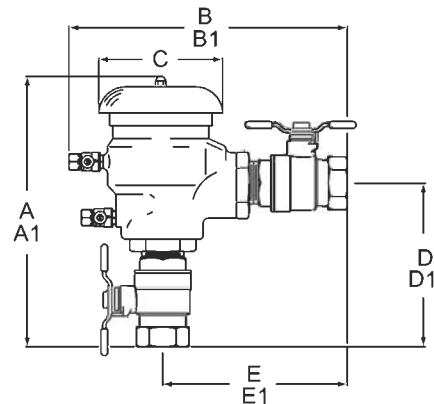

U.S. - Inches	A	A1 Union BV	B	B1 Union BV	C	D	D1 Union BV	E	E1 Union BV	lbs.
1/2	6 1/4	7	6 3/4	7 1/2	2 1/2	3 3/4	4 1/2	4 1/4	5	2.6
3/4	6 1/2	7 3/8	7	7 7/8	2 1/2	4	4 7/8	4 1/2	5 3/8	2.9
1	8 3/4	9 5/8	9	9 15/16	4	5 1/4	6 3/16	6	6 15/16	5.9
1 1/4	9 1/4	10 1/4	10	11	4	6 1/4	7 1/4	7	8	7.0
1 1/2	11 3/4	12 7/8	11 1/2	12 5/8	6 1/2	7 1/4	8 3/8	7 3/4	8 7/8	14.8
2	12 1/2	13 3/4	12 1/4	13 1/2	6 1/2	8	9 1/4	8 1/2	9 3/4	16.5

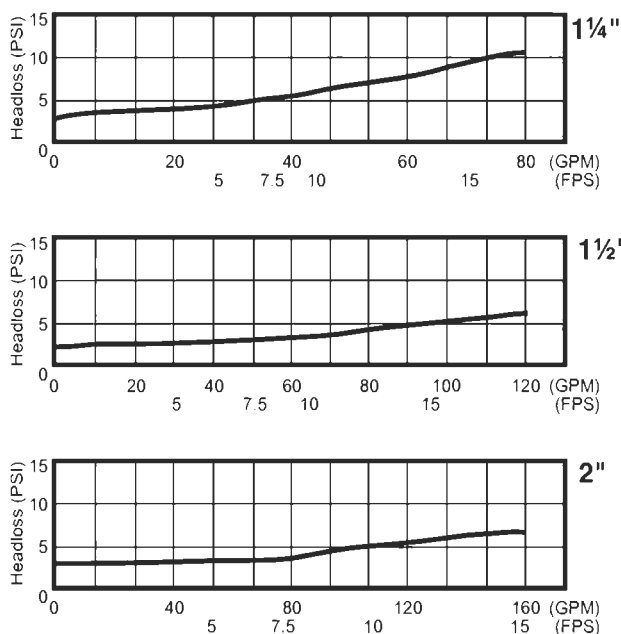
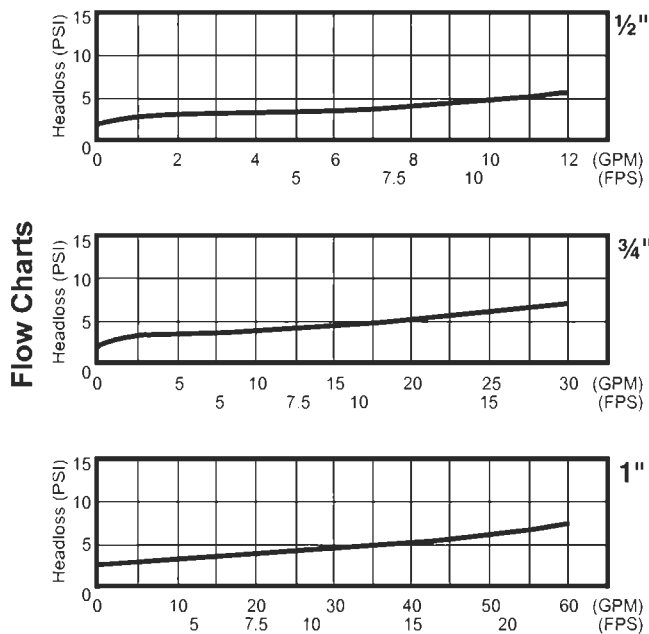

### Compliance

Approved by the Foundation for Cross-Connection Control and Hydraulic Research at the University of Southern California.<sup>33</sup>

ASSE Listed (Std. 1020)

CAN/CSA Certified (B64.1.2)

IAPMO® Listed

\* Valves must be supplied with resilient seated ball valve shut-off's and test cocks for USC's approval to be effective.\*

### Characteristics & Materials

Maximum working pressure: 150 psi (1034 KPa)

Hydrostatic test pressure: 300 psi (2069 KPa)

Temperature range: 32°F to 140°F  
(0°C to 60°C)

Fluid: Water

End detail (1/2" - 2"): Threaded ANSI B2.1

Main valve body: Bronze

Elastomers: Nitrile

MODEL 765

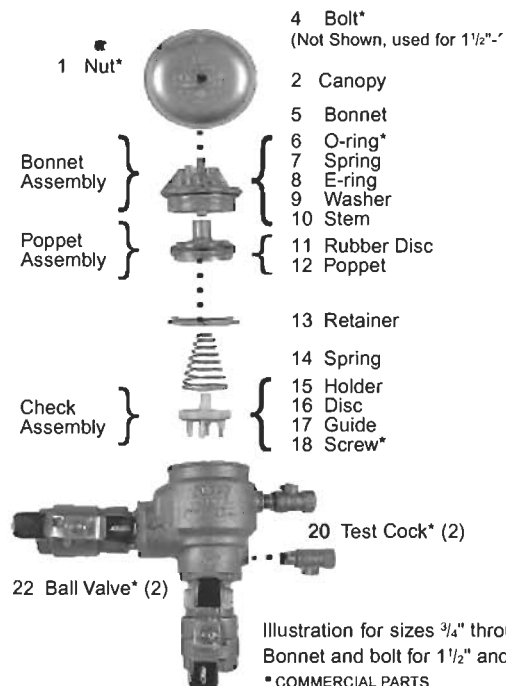

Illustration for sizes 3/4" through 1 1/4" only. Bonnet and bolt for 1 1/2" and 2" not shown. \* COMMERCIAL PARTS

### Parts & Repair Kits

Fig. No.	Description	Quantity	765 1/2"	765 3/4"	765 1"	765 1 1/4"	765 1 1/2"	765 2"
1	Nut		523-533-00	523-533-00	523-543-00	523-543-00	523-543-00	523-543-00
2	Canopy		300-092	300-093	300-089	300-089	300-094	300-083
4	Bolt	6	-	-	-	-	511-514-06	511-514-06
6	O-Ring		398-026-72	398-026-72	398-140-72	398-140-72	398-247-72	398-247-72
7	Spring		-	-	-	-	630-096	630-096
10	Stem		-	-	-	-	200-767	200-767
13	Retainer		300-096	300-096	300-088	300-088	-	-
14	Spring		630-108	630-108	630-106	630-106	630-063	630-063
20	Test Cock	2	781-074	781-074	781-075	781-075	781-075	781-075
22	Ball Valve	2	781-047	781-048	781-049	781-050	781-051	781-052
	<b>Rubber Parts Kit (6, 11, 16)</b>		<b>905-020</b>	<b>905-020</b>	<b>905-021</b>	<b>905-021</b>	<b>905-022</b>	<b>905-022</b>
	<b>Bonnet Assembly (5-10)</b>		<b>905-047</b>	<b>905-047</b>	<b>905-048</b>	<b>905-048</b>	-	-
	<b>Bonnet/Kit (3, 5-10)</b>		-	-	-	-	<b>901-857</b>	<b>901-857</b>
	<b>Poppet Assembly (11, 12)</b>		<b>905-049</b>	<b>905-049</b>	<b>905-050</b>	<b>905-050</b>	<b>901-860</b>	<b>901-860</b>
	<b>Check Assembly (15-18)</b>		<b>905-051</b>	<b>905-051</b>	<b>905-052</b>	<b>905-052</b>	-	-
	<b>Check Repair Kit (6, 13, 15-18)</b>		-	-	-	-	<b>905-070</b>	<b>905-070</b>
	<b>Bonnet/Poppet Kit (5-12)</b>		<b>905-211</b>	<b>905-211</b>	<b>905-212</b>	<b>905-212</b>	-	-