

## 1" & 1-1/4" Beeco Model 10 Reduced Pressure Principle Backflow Preventer

### APPROVALS

Meets the full requirements of USC's FCCC & HR, IAPMO, Southern Building Code Congress, AWWA.

### DESCRIPTION

The Model 10 reduced pressure principle backflow preventer consists of a spring-loaded, diaphragm assisted main check valve and a spring-loaded second check valve. Located in the zone between the valves is a spring-loaded, diaphragm actuated, differential pressure relief valve. This unit differs from the rest of the Beeco line in that it's first valve is diaphragm assisted instead of a poppet check.

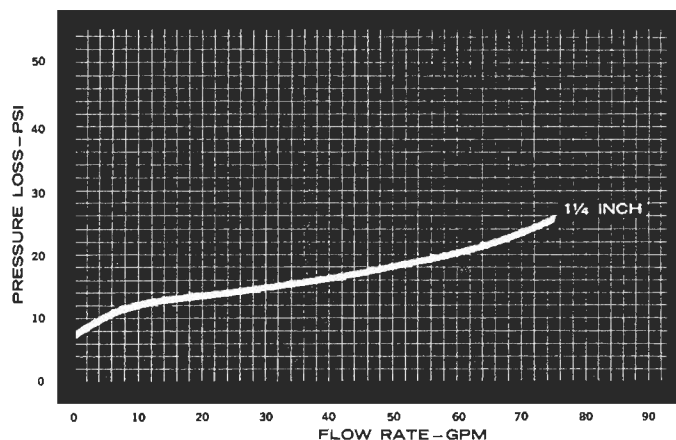

### MATERIALS & CHARACTERISTICS

<b>BODY</b> <b>WORKING PARTS</b> <b>SPRINGS</b> <b>VALVE DISCS</b> <b>DIAPHRAGMS</b>	BRONZE BRONZE STAINLESS STEEL NEOPRENE NEOPRENE COATED COTTON DUCK
MAX WORKING PRESSURE HYDROSTATIC TEST PRESSURE TEMPERATURE RANGE	175 PSI 350 PSI 32°F — 145°F

### FEATURES

Body material is galvanized cast iron or bronze, depending on size or version.  
Not all seats replaceable.

First check and relief valve springs are contained.

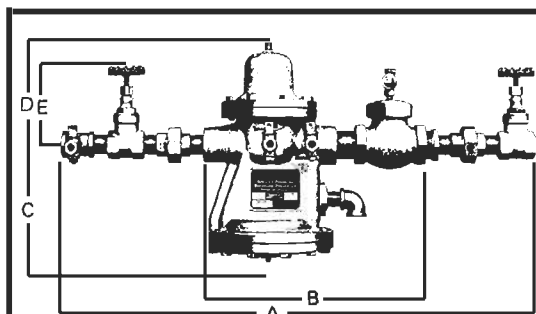

### DIMENSIONS

1" dimensions unavailable

	1 1/4	1 1/4
SIZE	1 1/4	1 1/4
END DETAIL	SCR	FLG
RATED GPM	75	75
A	37	28
B	16	20
C	9	9
D	7	7
E	6	6
RELIEF VALVE OPENING	3/4	3/4
SIZE OF TEST COCKS	1/4	1/4
NET WT. NO VALVES	66	70
WITH VALVES	77	88
GROSS WT. NO VALVES	83	75
WITH VALVES	95	93

**MAIN VALVE PARTS**

1	MV Spring Retainer Nut	90069
2	MV Spring Retainer	62017
3	MV Spring	62014
4	MV Clamp Nut	90341
5	MV Spring Guide Washer	62023
6	MV Diaphragm Plate	62020
7	MV Diaphragm	62021
8	MV Disc Holder	62018
9	MV Disc	62022
0	MV Guide	61809
1	MV Disc Cap Screw	90065
	MV Cover Plug	59005
	MV Cover Cap Screw	90180

**CHECK VALVE PARTS**

1	CV Spring	62019
2	CV Disc Holder	62024
3	CV Disc	62012
4	CV Guide	62310

**RELIEF VALVE PARTS**

1	RV Seat	61669	1
1A	RV Seat O-Ring*	61292	1
2	RV Stud	61656	1
3	RV Guide	61673	1
4	RV Disc	61658	2
5	RV Spacer	61667	1
6	RV Housing	61666	1
7	RV Clamp Bolt	61665	1
8	RV Clamp Bolt Gasket	61674	1
9	RV Spring	61655	1
10	RV Upper Diaphragm Plate	61650	1
11	RV Diaphragm	61662	2
12	RV Lower Diaphragm Plate	61651	1
13	RV Clamp Bolt Nut	90341	1
14	RV Housing Gasket	61661	1
15	RV Locknut	61664	1
	RV Cover Cap Screw	90180	12
	RV Drain Plug	59007	1
	RV Close Nipple	96055	1
	RV Elbow	96036	1

**FITTINGS**

Nipple	96072	1
Reducing Bushing	96050	1
Test Cock Nipple	96280	1
Test Cock Plug	59005	2
Test Cock	60012	3
Test Cock Close Nipple	96299	2

**RUBBER PARTS KIT**

CV Disc	62012	1
RV Disc	61658	2
RV Diaphragm	61662	2
RV Clamp Bolt Gasket	61674	1
RV Housing Gasket	61661	1
MV Diaphragm	62021	2
MV Disc	62022	1
RV Seat O-Ring*	61292	1

\*Not required on pre-1968 models.

**MAIN VALVE**

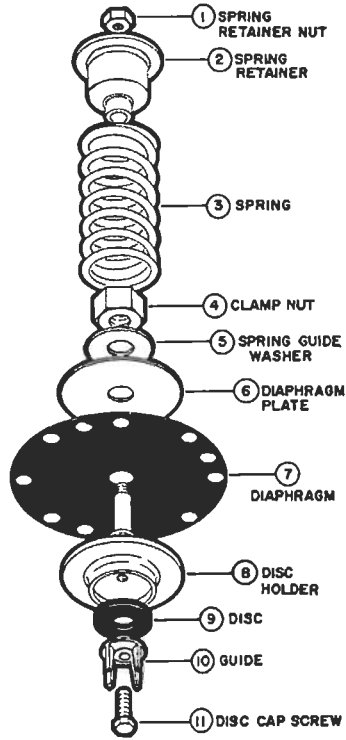

**CHECK VALVE**

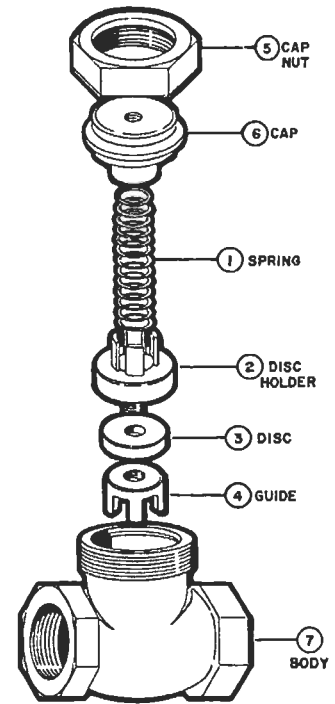

**RELIEF VALVE**

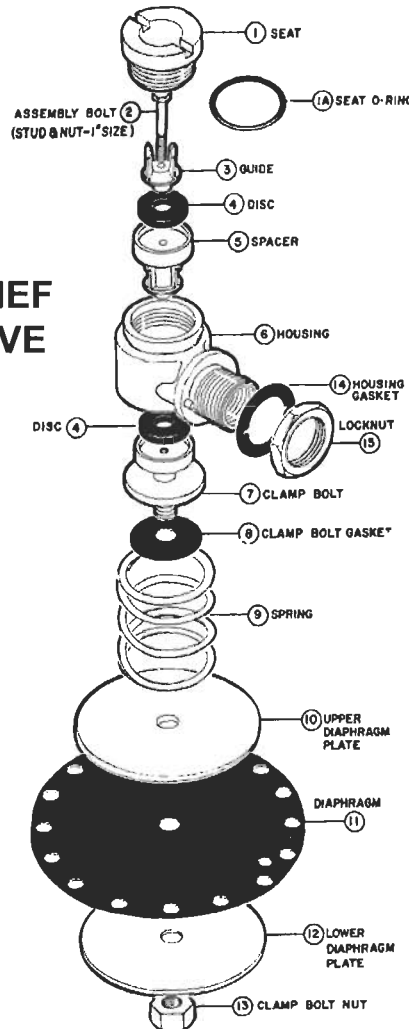

**MODEL 10**