

DESCRIPTION

This is a double check assembly that was produced around 1975 to 1978. It is a lead weight loaded swing check valve. It features replaceable check seats, removable with a seat removal tool.

DIMENSIONS

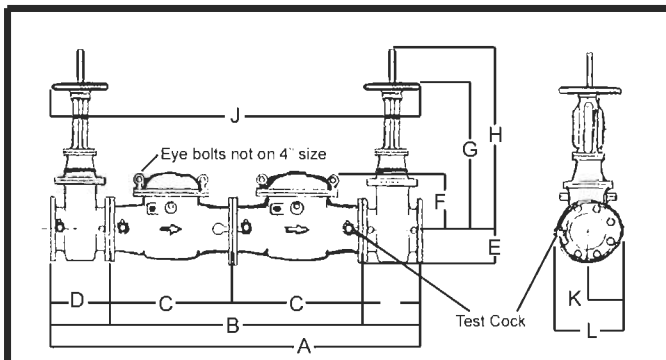

	4"	6"	8"	10"				
A	51-3/16	66-3/16	76-3/16	98-3/16				
B	33-1/16	45-1/16	53-1/16	72-1/16				
C	16-1/2	22-1/2	26-1/2	36				
D	9	10-1/2	11-1/2	13				
E	5	6	7-1/2	9-3/4				
F	8-1/2	11-3/4	14-7/8	16-3/4				
G	18	22-5/16	27-9/16	32-1/4				
H (open)	23-1/8	31-11/16	40-3/8	49				
J	52-3/16	67-11/16	78-11/16	101-3/16				
K	7-1/16	8-1/8	10-1/8	10-5/16				
L	12-5/16	14-9/16	18	19-11/16				
Gate Valve Type	N.R.S.	O.S.&Y.	N.R.S.	O.S.&Y.	N.R.S.	O.S.&Y.	N.R.S.	O.S.&Y.
Net Weight - Lbs.	438	472	840	880	1440	1516	2422	2550
Gross Weight - Lbs.	513	547	910	950	1540	1616	2372	2700

FLOW CURVES

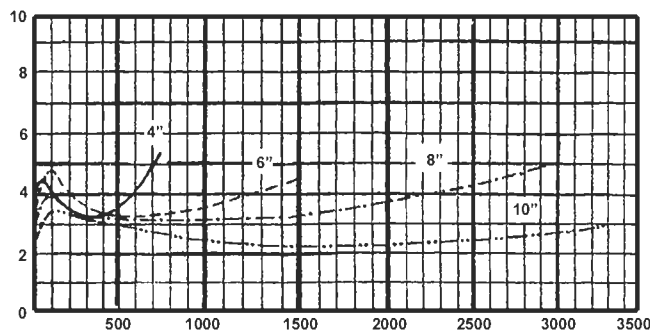

Hersey Meters

Model E1 Double Check Valve Backflow Prevention Assembly (4", 10")

MATERIALS & CHARACTERISTICS

BODY	HOT DIPPED GALVANIZED CAST IRON
CLAPPER ARM SHAFTS SEATS	BRONZE STAINLESS STEEL BRONZE, TIN PLATED
MAXIMUM WORKING PRESSURE	175 P.S.I.
TEMPERATURE RANGE	33°-180°F

REPAIR PARTS

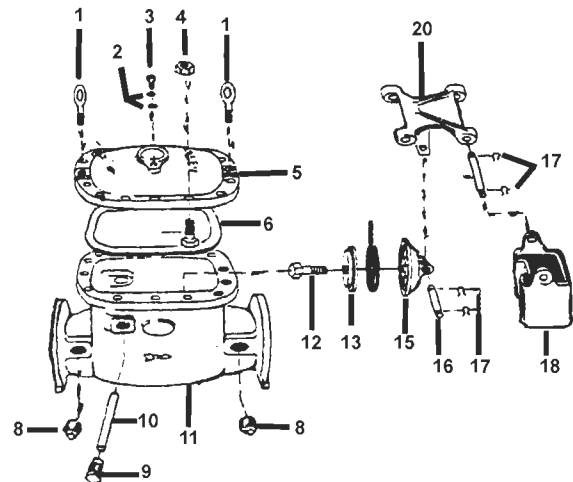

10
Beeco
Hersey
Craneline

Individual Parts

- | | |
|------------------|----------------|
| 1 Eye Bolt | 11 Body |
| 2 Air Screw Wshr | 12 Bolt |
| 3 Air Screw | 13 Disc Ret |
| 4 Nut | 14 Disc |
| 5 Cover | 15 Disc Holder |
| 6 Cvr Gskt | 16 Pin |
| 7 Bolt | 17 Pin Clip |
| 8 Plug | 18 Weight |
| 9 Plug | 19 Pin |
| 10 Pin | 20 Cross Arm |