

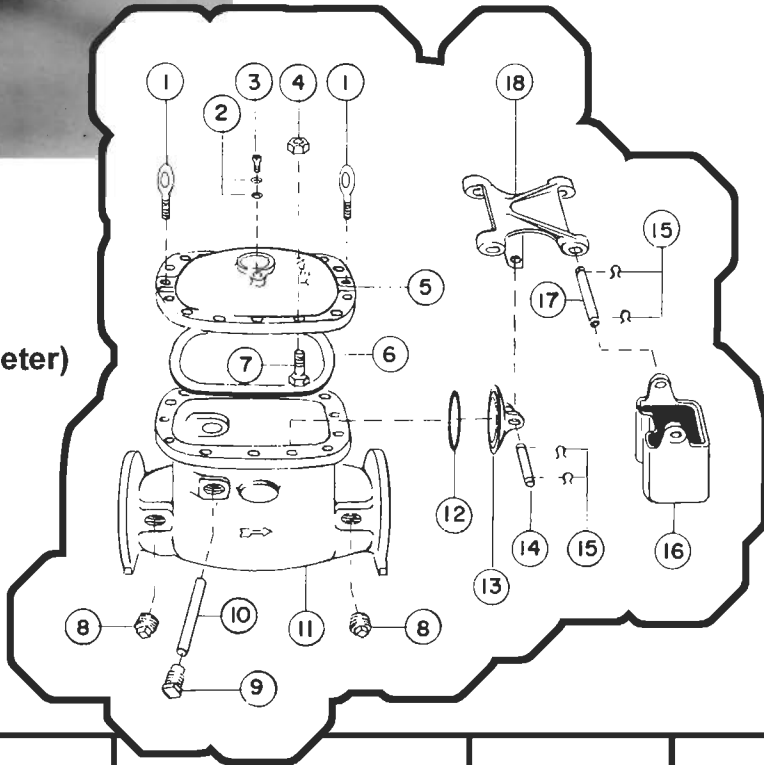

Hersey Meters

**Model E.D.C.
Detector Check
(4", 6", 8", 10")**

(Diagram without bypass meter)



INDIVIDUAL PARTS

ILLUS. NO.	DESCRIPTION	4"	6"	8"	10"
1	EYE BOLT (2)	—	90199	90199	90199
2	VENT SCREW WASHER (2)	59073	59073	59073	59073
3	VENT SCREW	59003	59003	59003	59003
4	HEX NUT (8) (12) (14) (18)	90251	90251	90251	90251
5	COVER *	55682	56482	57482	58482
6	GASKET	55683	56483	57483	58483
7	HEX BOLT (8) (12) (14) (18)	90135	90135	90135	90135
8	PLUG (2)	59012	59013	59014	59014
9	HINGE PIN PLUG (2)	55689	56489	57489	58489
10	HINGE PIN	55690	56490	57490	58490
11	BOTTOM CASE W/SEAT *	55681	56481	57481	58481
12	CLAPPER "O" RING	98310	98311	98312	98345
13	CLAPPER	55685	56485	57485	58485
14	CLAPPER PIN	55692	56492	57492	58492
15	PIN CLIP (4)	55697	55324	57497	57497
16	WEIGHT LEADED	55687	56487	57487	58487
17	WEIGHT PIN	55691	56491	57491	58491
18	SWING ARM	55688	56488	57488	58488

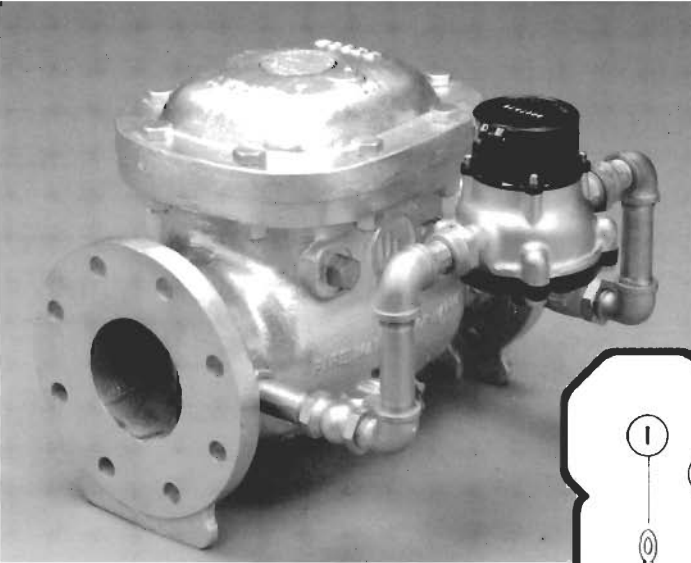

Hersey Meters

Model E.D.C. II Detector Check (4", 6", 8", 10")

(Diagram without bypass meter)

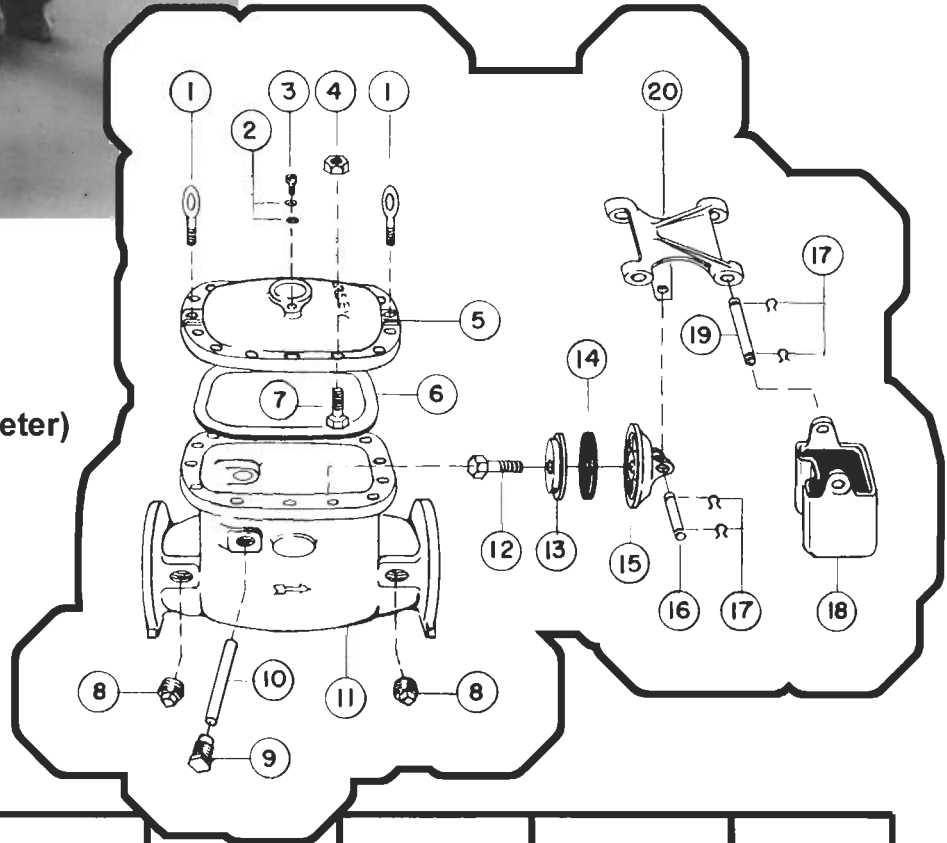

INDIVIDUAL PARTS

ILLUS. NO.	DESCRIPTION	4"	6"	8"	10"
1	EYE BOLT (2)	—	90199	90199	90199
2	VENT SCREW WASHER (2)	59073	59073	59073	59073
3	VENT SCREW	59003	59003	59003	59003
4	HEX NUT (8) (12) (14) (18)	90251	90251	90251	90251
5	COVER *	55682	56482	57482	58482
6	GASKET	55683	56483	57483	58483
7	HEX BOLT (8) (12) (14) (18)	90135	90135	90135	90135
8	PLUG (2)	59012	59013	59014	59014
9	HINGE PIN PLUG (2)	55689	56489	57489	58489
10	HINGE PIN	55690	56490	57490	58490
11	BOTTOM CASE W/SEAT *	55681	56481	57481	58481
12	CAP SCREW	90115	90172	90282	90382
13	CLAPPER DISC	55367	56474	57474	58474
14	CLAPPER RUBBER	55677	56477	57477	58477
15	CLAPPER	55671	56471	57471	58471
16	CLAPPER PIN	55692	56492	57492	58492
17	PIN CLIP (4)	not available	not available	not available	not available
18	WEIGHT LEADED	55687	56487	57487	58487
19	WEIGHT PIN	55691	56491	57491	58491
20	SWING ARM	55688	56488	57488	58488



Hersey Meters

Model EDC III Spring Loaded Lever Detector Check Valves (4", 6", 8", 10")

MATERIALS & CHARACTERISTICS

Max. Working Pressure:	175 PSI
Hydrostatic Test Pressure:	350 PSI
Temperature Range:	33°F to 100°F
Value Body Standard:	Fusion bonded epoxy on cast iron; Option - Red Paint
Clapper Seat:	Rubber to Bronze
Optional Bypass Meter Case:	Bronze
Optional Bypass Register:	Sealed Plastic
Optional Bypass Interior:	Plastic

APPLICATIONS

For installation in commercial fire lines, or any water supply system to detect leakage or unauthorized use. Designed for horizontal installation.

DESCRIPTION

HERSEY Model EDC III Detector Check Valves consist of a main check valve with a rubber seal, operated by a weighted lever (available with optional trim kit and bypass meter). The Model EDC III prevents water from re-entering the potable water system, while detecting leaks in the fire sprinkler system or unauthorized use of sprinkler system water. The optional bypass is comprised of a shutoff valve, swing check, and a Hersey Model MVR magnetic turbine meter, or a Hersey Model 400/500 IIS positive displacement meter. Solid state remote reading systems are available for all meters offered with the Model EDC III.

OPERATION

With the mainline valve held closed by the weighted lever, any low flow will be directed through the bypass and measured by the bypass meter. When the pressure loss through the bypass is approximately 1.5 psi, the mainline valve opens automatically, allowing unrestricted flow. The mainline valve and check on the bypass prevent loss of water from the system. Closing the inlet shutoff valve permits in-line servicing of the bypass meter while the mainline remains in service.

CONNECTIONS: Flange x Flange.

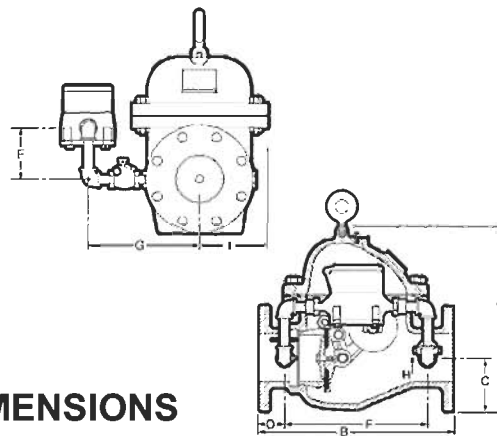

DIMENSIONS

Size	4"	6"	8"	10"	
A	16"	20-1/4"	24"	27-1/4"	
B	16-1/2"	22-1/2"	25"	26"	
C	4-1/2"	5-1/2"	6-3/4"	8"	
D	2-3/8"	3"	3-5/16"	4-3/4"	
F	11-3/32"	16-1/2"	18"	18-1/2"	
H	1	1-1/2"	2"	2"	
I	5-7/8"	7-1/16"	8"	8-1/8"	
Meter Size	E* All Values	G*			
		4"	6"	8"	10"
5/8"	7"	8-5/8"	9-5/8"	9-5/8"	-
5/8"x3/4"	7"	8-5/8"	9-5/8"	10-7/8"	10-7/8"
3/4"	7"	-	9-5/8"	10-7/8"	-
1"	8"	-	12-7/8"	14-1/8"	15-1/4"
Size	4"	6"	8"	10"	
Net Wt. No Bypass Lbs.	165	315	427	565	

APPROVALS

Underwriters Laboratories (UL) Listed; Factory Mutual (FM) approved

MODEL EDC III

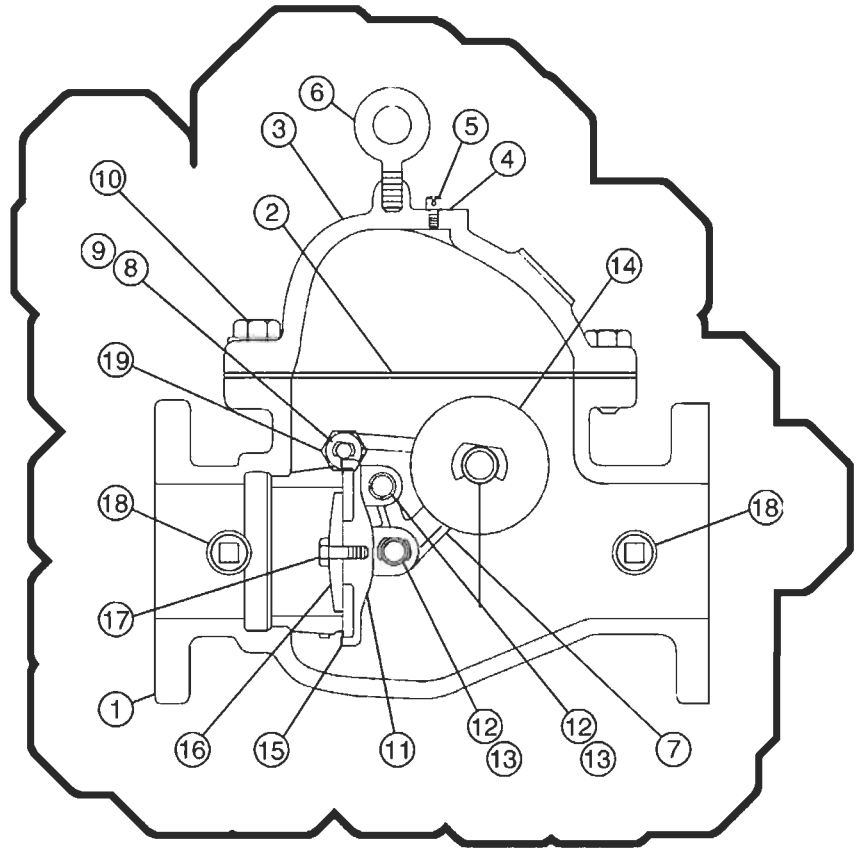

INDIVIDUAL PARTS

Ref. No.	Description	4" Model	6" Model	8" Model	10" Model
1	Body with Brass Seat Ring	N/A	N/A	N/A	N/A
2	Cover Gasket	196326	196327	196328	196329
3	Cover	55644	56444	57447	58414
4	Vent Screw Washer	59073	59073	59073	59073
5	Vent Screw	59003	59003	59003	59003
6	Eye Bolt	AS7731	AS7732	AS7732	AS7732
7	Clapper Arm	144123	144130	144145	144161
8	Hinge Pin Clip	196310 (2)	196310 (2)	196311 (2)	196311 (2)
9	Hinge Pin Washer	196312 (2)	196312 (2)	196313 (2)	196313 (2)
10	Cap Screw	90243 (8)	196000 (10)	90338 (12)	90338 (12)
11	Clapper	144119	144132	144147	144163
12	Clapper Pin	55643 (3)	56443 (3)	57446 (2) 57443 (1)	58415 (3)
13	Pin Clip	57498 (6)	57498 (6)	56383 (4) 57498 (2)	56383 (6)
14	Weight	159672	159673	283304	159675
15	Clapper Seat	196124	196149	196142	196409
16	Clapper Plate	144120	144133	144148	144164
17	Clapper Bolt	196323	196323	196324	196325
18	Pipe Plug	59008 (4)	59009 (4)	59010 (4)	59010 (4)
19	Pivot Shaft	144116 (2)	144131 (2)	144146 (2)	144162 (2)