

**WILKINS**  
a ZURN company

## Model S Cast Bronze "Y" Strainer

### FEATURES

Sizes:  1/2"  3/4"  1"  1 1/4"  
 1 1/2"  2"  2 1/2"  3"

Temperature/pressure rating 150 psi steam  
300 psi WOG  
ANSI B1.20.1

Threaded connections (FNPT)  
(Supplied with brass closure plug)

### APPLICATION

Recommended for a variety of water service lines including residential and commercial irrigation, swimming pools and cooling tower water. They are also designed to protect delicate equipment such as regulators and backflow preventers by filtering sediment which could cause premature failure. For steam service, Model S Strainers protect control valves, traps, sterilizers and other process equipment.

### FLOW CURVES

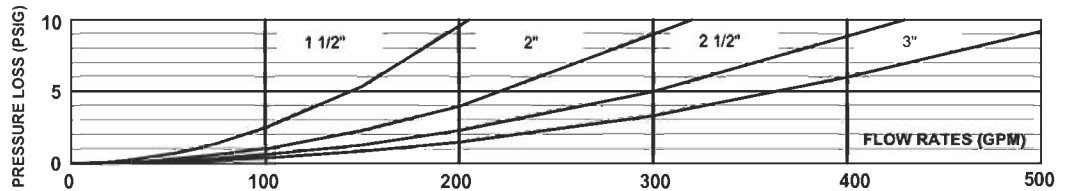
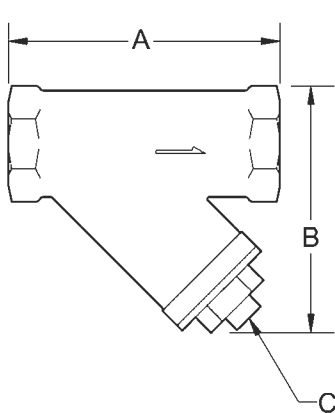
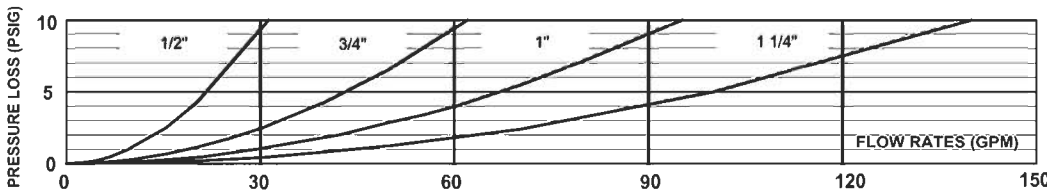

### MATERIALS

Main valve body Cast Bronze ASTM B 584  
Access covers Bronze ASTM B 584  
Screens 20 Mesh Stainless Steel, 300 Series

### DIMENSIONS & WEIGHTS

SIZE		DIMENSIONS (approximate)						WEIGHT	
		A		B		C			
in.	mm	in.	mm	in.	mm	in.	lbs.	kg.	
1/2	15	3 1/4	83	3	76	3/8 NPT	1	0.5	
3/4	20	3 7/8	98	3 1/2	89	3/8 NPT	1 1/4	0.6	
1	25	4 1/2	114	4	102	1/2 NPT	1 3/4	0.8	
1 1/4	32	5 5/16	135	4 3/4	121	1/2 NPT	2 3/4	1.2	
1 1/2	40	6 5/16	160	5	127	1/2 NPT	3 1/2	1.6	
2	50	7 1/2	191	6	152	1/2 NPT	6	2.7	
2 1/2	65	9	229	7 1/2	191	1/2 NPT	9 1/4	4.2	
3	80	10	254	8 1/2	216	1/2 NPT	14	6.4	

Pipe size	Capacity thru Schedule 40 Pipe			
	5 ft/sec	7.5 ft/sec	10 ft/sec	15 ft/sec
1/8"	1	1	2	3
1/4"	2	2	3	5
3/8"	3	4	6	9
1/2"	5	7	9	14
3/4"	8	12	17	25
1"	13	20	27	40
1 1/4"	23	35	47	70
1 1/2"	32	48	63	95
2"	52	78	105	167

