



3/4" 007M3QT



2" 007M1QT HC



## Series 007 Double Check Valve Assemblies

Sizes: 1/2" – 3" (15 – 80mm)

### DESCRIPTION

Series 007 Double Check Valve Assemblies shall be installed at referenced cross-connections to prevent the backflow of polluted water into the potable water supply. Only those cross-connections identified by local inspection authorities as non-health hazard shall be allowed the use of an approved double check valve assembly.

Check with local authority having jurisdiction regarding vertical orientation, frequency of testing or other installation requirements.

### FEATURES

- Ease of maintenance — only one cover
- Top entry
- Replaceable seats and seat discs
- Modular construction
- Compact design
- Cast bronze body construction — 1/2" – 2" (15 – 50mm)
- Fused epoxy coated cast iron body — 2 1/2" – 3" (65 – 80mm)
- Top mounted ball valve test cocks
- Low pressure drop
- No special tools required for servicing
- 1/2" – 1" (15 – 25mm) have tee handles

### SPECIFICATIONS

A Double Check Valve Assembly shall be installed at each noted location. The assembly shall consist of two positive seating check modules with captured springs and rubber seat discs. The check module seats and seat discs shall be replaceable. Service of all internal components shall be through a single access cover secured with stainless steel bolts. The assembly shall also include two resilient seated isolation valves; four top mounted, resilient seated test cocks.

### STANDARDS

ASSE Std. 1015, AWWA Std. C510  
IAPMO PS31, CSA B64.5

### MODELS

1/2" – 2" (15 – 50mm)

Suffix:

S - bronze strainer

LF - without shutoff valves

LH - locking handle ball valves (open position)

SH - stainless steel ball valve handles

HC - 2 1/2" inlet/outlet fire hydrant fittings (2" valve)

Prefix:

U - Union connections

2 1/2" – 3" (65 – 80mm)

Suffix:

NRS - non-rising stem resilient seated gate valves

OSY - UL/FM outside stem and yoke resilient seated gate valves

LF - without shutoff valves

QT-FDA - FDA epoxy coated quarter-turn ball valves

### PRESSURE - TEMPERATURE

1/2" – 2" (15 – 50mm)

Temperature Range: 33°F – 180°F (5°C – 82°C).

Maximum Working Pressure: 175psi (12.06 bars).

2 1/2" – 3" (65 – 80mm)

Temperature Range: 33°F – 110°F (5°C – 43°C) continuous,  
140°F (60°C) intermittent.

Maximum Working Pressure: 175psi (12.06 bars).

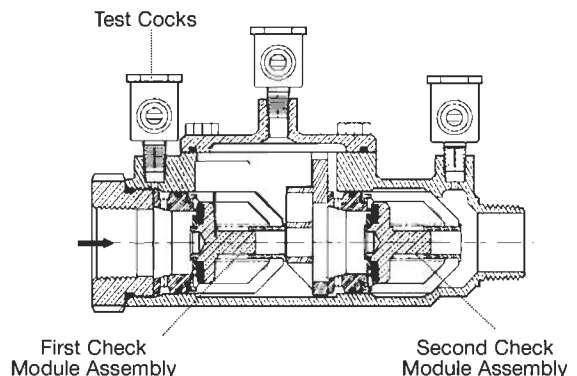

# Series 007

## DIMENSIONS & WEIGHTS

Sizes: 1/2" - 2"

MODEL	SIZE	DIMENSIONS								WEIGHT lbs.
		A	B	C	D	F	G	R	T	
†▲007QT	1/2	10	4 5/8	2 1/16	—	5	3 3/8	2 5/16	2 1/16	4.5
†▲007M3QT	3/4	11 1/8	4	3 1/8	—	6 3/16	3 1/16	2 1/8	1 5/16	5
†▲007M1QT	1	13 1/4	5 1/8	4	—	7 1/2	3 3/8	1 1 1/16	1 1 1/16	12
†▲007M2QT	1 1/4	16 3/8	5	3 5/16	—	9 1/2	5	3	2	15
†▲007M2QT	1 1/2	16 3/4	4 7/8	3 1/2	—	9 3/4	5 13/16	3 1/8	2 1 1/16	15.9
†▲007M1QT	2	19 1/2	6 1/4	4	—	13 3/8	6 1/4	3 3/16	2 1 1/16	25.7
• 007QT-S	1/2	13	6	2 7/16	3	5	3 3/8	2 5/16	2 1/16	5.5
• 007M3QT-S	3/4	14 1/2	6 1/8	3 1/8	3	6 3/16	3 1/16	2 1/8	1 5/16	6.7
• 007M1QT-S	1	17 15/16	7 3/4	4	3 1/4	7 1/2	3 3/8	1 1 1/16	1 1 1/16	14
• 007M2QT-S	1 1/4	21 1/2	7 1/16	3 5/16	3 1/2	9 1/2	5	3	2	19
• 007M2QT-S	1 1/2	25 1/16	7 1/16	3 1/2	3 3/4	9 3/4	5 13/16	3 1/8	2 1 1/16	19.6
• 007M1QT-S	2	27 1/4	8 3/4	4	4	13 3/8	6 1/8	3 3/16	2 1 1/16	33.5

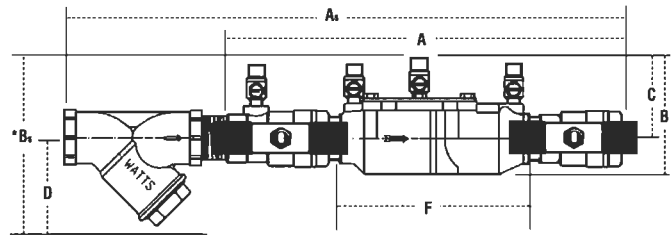

\*Subscript 'S' = strainer model

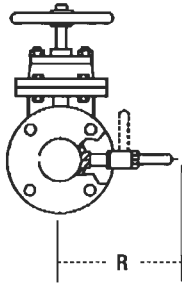
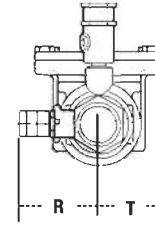

Sizes: 2 1/2" - 3"

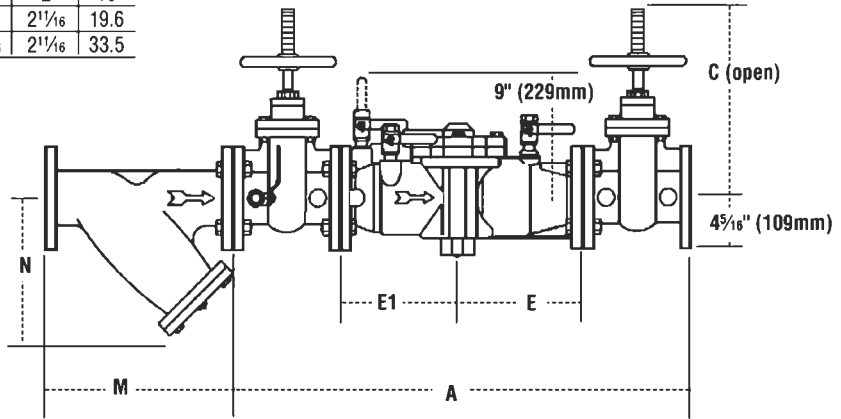

MODEL	SIZE	DIMENSIONS					WEIGHT lbs.
		A	C	E, E1	R		
007QT-FDA	2 1/2	33 1/8	6 3/8	9 1/16	8 3/4	155	
▲ 007-NRS	2 1/2	33 1/8	9 3/8	9 1/16	8 3/4	155	
▲◆ 007-OSY	2 1/2	33 1/8	16 3/8	9 1/16	8 3/4	158	
007-QT-FDA	3	34 1/8	6 3/8	9 1/16	8 3/4	155	
▲◆ 007-NRS	3	34 1/8	10 1/4	9 1/16	8 3/4	185	
▲ 007-OSY	3	34 1/8	18 3/8	9 1/16	8 3/4	185	

Stainer Dimensions			
SIZE	M	N	lbs
2 1/2	10	6 1/2	28
3*	10 1/8	7	34

\*S Models only

1" U007M1QT

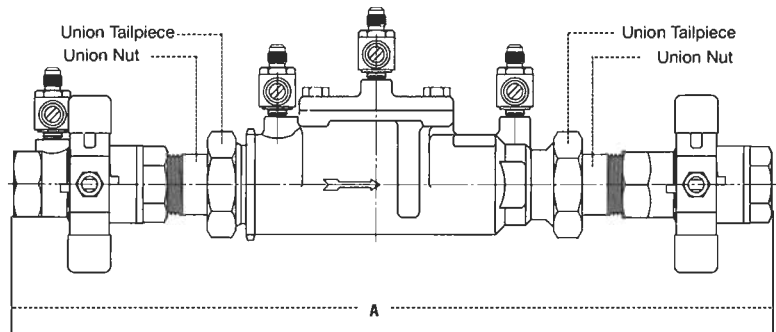

## APPROVALS

- † ASSE, AWWA, IAPMO, CSA, UPC
- ▲ Approved by the Foundation for Cross-Connection Control and Hydraulic Research at the University of Southern California.
- Models LF and S are not listed.
- ◆ UL Classified (LF models only) 3/4" - 2" (19 - 50mm)
- ◆ UL Classified with OSY gate valves (2 1/2" & 3")
- \* Horizontal and vertical "flow up" approval on all sizes.

MODEL	SIZE	DIMENSIONS
		A
U007QT	1/2	12 13/16
U007M2QT	3/4	13 13/16
U007M2QT	1	16 3/8
U007M2QT	1 1/4	20 3/4
U007M2QT	1 1/2	21 1/2
U007M1QT	2	24 1/2

## FLOW CURVES - Series 007

\* Typical maximum system flow rate (7.5 feet/sec., 2.3 meters/sec.)  
 \*\* UL rated flow

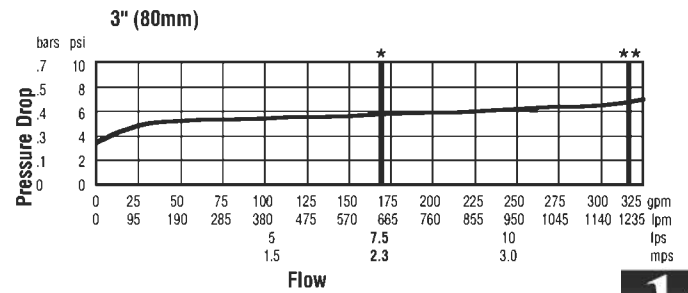
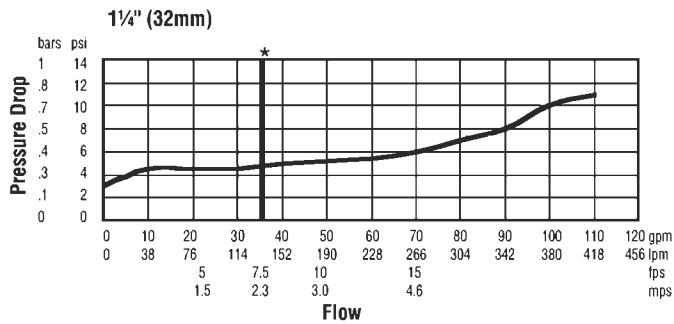
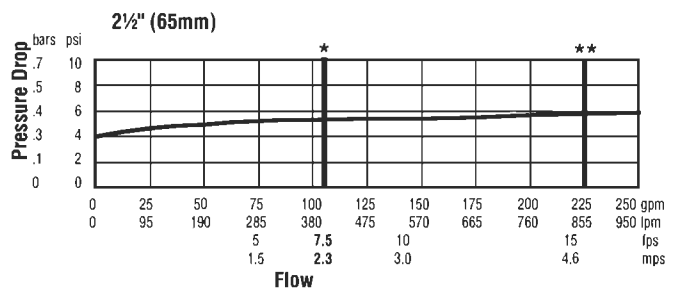
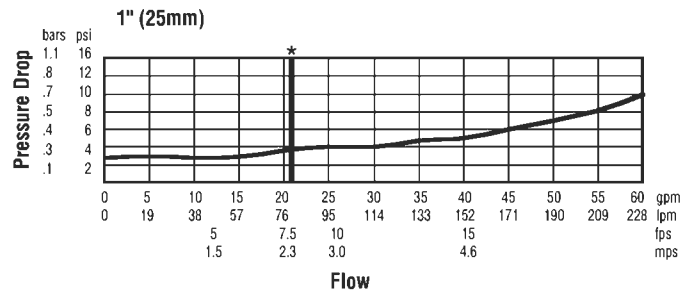
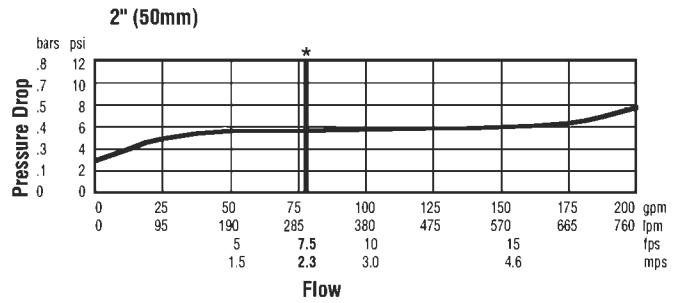
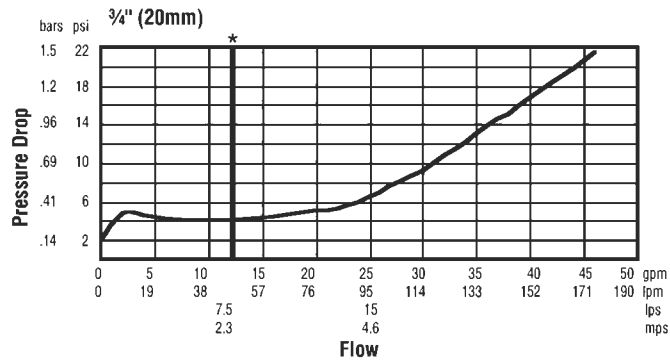
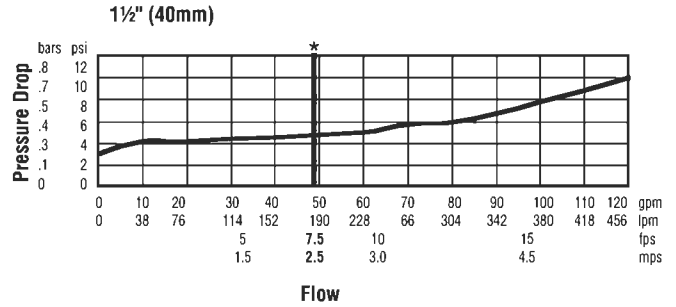
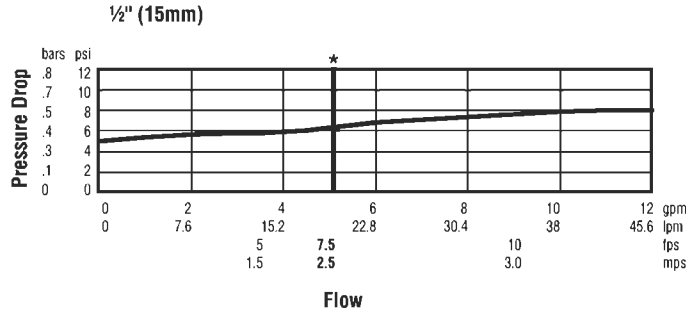

# 2½" and 3" Series 007 Replacement Parts ½" - 2"

## First Check Kit

ORDERING CODE	KIT NO.	SIZE
0887285	RK 007 CK1	2½", 3"

**Kit Includes:** Seat, seat o-ring, disc assembly, spring, spring retainer, check cage and cover o-ring.

## Second Check Kit

ORDERING CODE	KIT NO.	SIZE
0887286	RK 007 CK2	2½", 3"

**Kit Includes:** Seat, seat o-ring, disc assembly, spring, spring retainer, check cage and cover o-ring.

## First and Second Check Rubber Parts

ORDERING CODE	KIT NO.	SIZE
0887287	RK 007 RT	2½", 3"

**Kit Includes:** Two seat discs, two seat o-rings, two cover o-rings.

## Cover Kit

ORDERING CODE	KIT NO.	SIZE
0887288	RK 007 C	2½", 3"

**Kit includes:** Cover and cover o-ring.

## Seat Kit

ORDERING CODE	KIT NO.	SIZE
0887289	RK 007 S	2½", 3"

**Kit Includes:** Seat and seat o-ring.

## Check Kits: 1st or 2nd Check

ORDERING CODE	KIT NO.	SIZE
0887193	RK 007 CK4	½"
0887026	RK 007M1 CK4	¾" - 1'
0887377	*RK SS007 CK4	½'
0888070	*RK SS007M3 CK1	½' - ¾'
0888071	*RK SS007M3 CK2	½' - ¾'
0887393	*RK SS007M2 CK1	¾'
0887397	*RK SS007M2 CK2	¾'
0887373	*RK SS007M1 CK4	1'

## 1st Check

0887023	RK 007 CK1	¾" - 1'
0887045	RK 007M2 CK1	¾'
0888550	RK 007M3 CK1	¾'
0887025	RK 007 CK1	1½" - 2"
0887186	RK 007M1 CK1	1½" - 2"
0887719	RK 007M2 CK1	1¼" - 1½"

## 2nd Check

0887024	RK 007 CK2	¾" - 1'
0887046	RK 007M2 CK2	¾'
0888551	RK 007M3 CK2	¾'
0887028	RK 007 CK2	1½" - 2"
0887187	RK 007M1 CK2	1½" - 2"
0887720	RK 007M2 CK2	1¼" - 1½"

## Stainless Steel 1st or 2nd Check

0887022	RK 007 CK1 SS	¾" - 1'
0887030	RK 007 CK2 SS	¾" - 1'
0887032	RK 007M1 CK4 SS	¾" - 1'
0887031	RK 007 CK1 SS	1½" - 2"
0887035	RK 007 CK2 SS	1½" - 2"
0887189	RK 007M1 CK1 SS	1½" - 2"
0887190	RK 007M1 CK2 SS	1½" - 2"

**Kit includes:** Seat, seat o-ring, disc assembly, spring, check cage, cover o-ring.

## Cover Kit

0887195	RK 007 C	½'
0887036	RK 007 C	¾" - 1'
0887038	RK 007M1 C	¾" - 1'
0887039	RK 007M2 C	¾'
0888553	RK 007M3 C	¾'
0887037	RK 007 C	1½" - 2"
0887191	RK 007M1 C	1½" - 2"
0887722	RK 007M2 C	1¼" - 1½"
0887379	*RK SS007 C	½'
0887380	*RK SS007M2 C	¾'
0888073	*RK SS007M3 C	½" - ¾'
0887381	*RK SS007M1 C	1'

**Kit includes:** Cover and cover o-ring

## Complete Rubber Parts

0887194	RK 007 RT	½'
0887040	RK 007 RT	¾" - 1'
0887042	RK 007M1 RT	¾" - 1'
0887043	RK 007M2 RT	¾'
0888552	RK 007M3 RT	¾'
0887041	RK 007 RT	1½" - 2"
0887188	RK 007M1 RT	1½" - 2"
0887721	RK 007M2 RT	1¼" - 1½"
0887378	*RK SS007 RT	½'
0887394	*RK SS007M2 RT	¾'
0888072	*RK SS007M3 RT	½" - ¾'
0887374	*RK SS007M1 RT	1'

**Kit includes:** Cover o-ring, two seat discs and two seat o-rings.

\*SS prefix denotes stainless steel body.

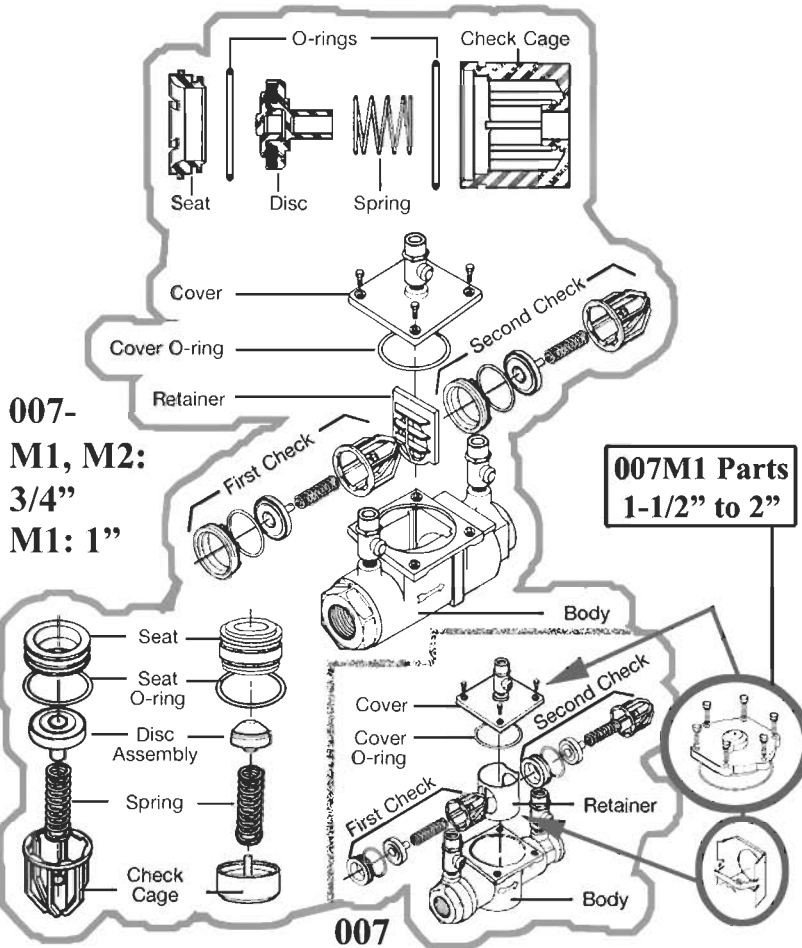

**007-  
M1, M2:  
3/4\"  
M1: 1\"**

**007M1 Parts  
1-1/2" to 2"**

**1/2" to 1"**

**Checks (all)**

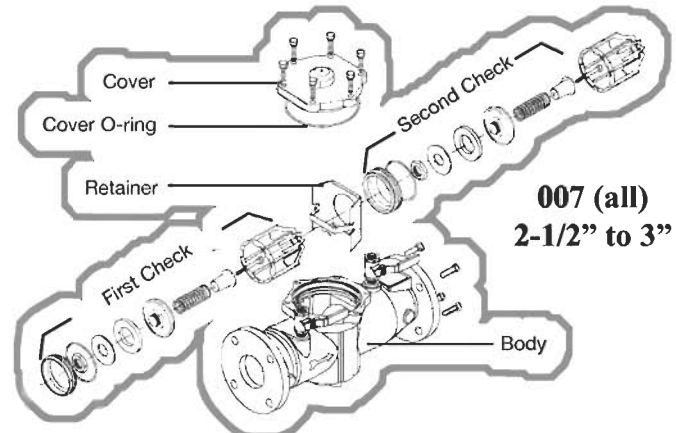
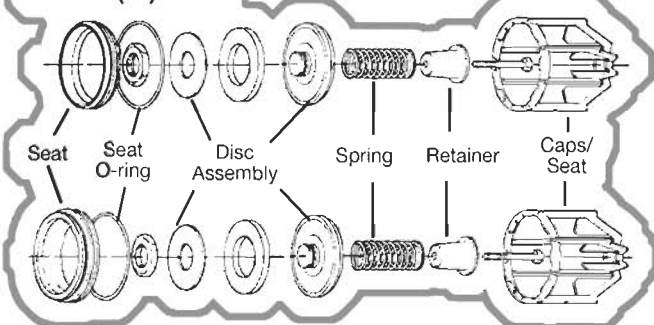

**007 (all)  
2-1/2" to 3"**