

757OSY

DESCRIPTION

Series 757/757N Double Check Valve Assemblies are used to prevent backflow of non-health hazard pollutants that are objectionable but not toxic, from entering the potable water supply system. Series 757/757N may be installed under continuous pressure service and may be subjected to backpressure and backsiphonage. Series 757/757N consists of two independently operating check valves, two shutoff valves, and four test cocks.

FEATURES

- Extremely compact design
- 70% Lighter than traditional designs
- 304 (Schedule 40) Stainless steel housing & sleeve
- Groove fittings allow integral pipeline adjustment
- Patented tri-link check provides lowest pressure loss
- Unmatched ease of serviceability
- Available with grooved butterfly valve shutoffs
- Available for horizontal, vertical or N pattern installations
- Replaceable check disc rubber
- Sizes 2½" and 3" available with quarter-turn ball valve shutoffs

FLOW CURVES

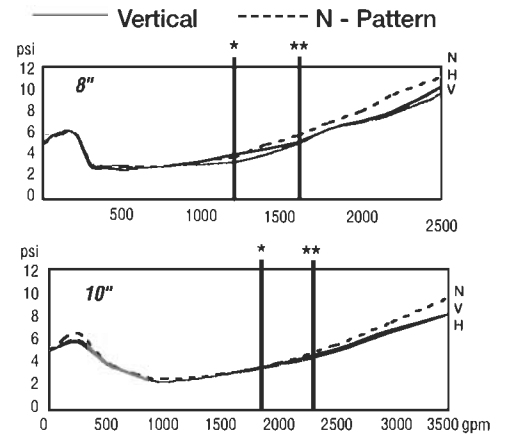
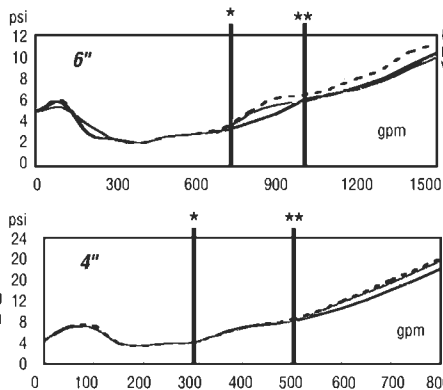
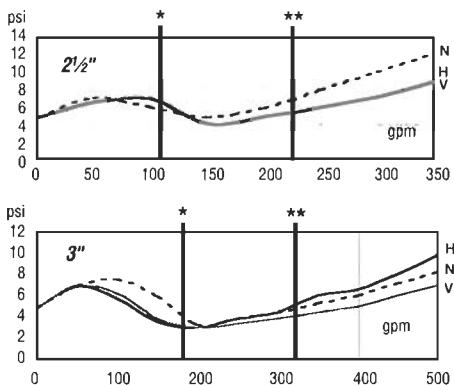

DIMENSIONS & WEIGHT

757QT

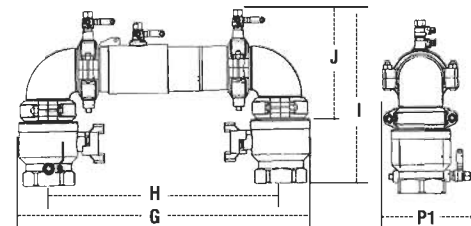
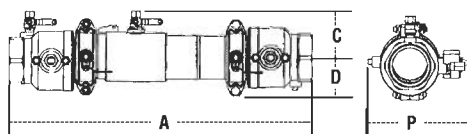

SIZE (DN)	DIMENSIONS									WEIGHT
	A	C	D	G	H	I	J	P	P1	
in.	in.	in.	in.	in.	in.	in.	in.	in.	in.	lbs.
2½	28 ¹⁵ / ₁₆	4 ⁷ / ₈	3 ¹³ / ₁₆	30 ¹ / ₄	24 ¹ / ₂	16 ⁹ / ₁₆	11 ³ / ₈	10 ¹ / ₁₆	8 ⁵ / ₁₆	35
3	30 ³ / ₁₆	4 ¹³ / ₁₆	3 ⁷ / ₈	30 ¹ / ₄	24 ¹ / ₂	17 ³ / ₁₆	11 ¹ / ₄	10 ⁷ / ₁₆	8 ⁵ / ₁₆	45



Series 757/757N Double Check Valve Assemblies

Sizes: 2½" – 10"

MODELS

Suffix:

NRS – non-rising stem resilient seated gate valves

OSY – UL/FM outside stem and yoke, resilient seated gate valves

BFG – UL/FM grooved gear operated butterfly valves with tamper switch

QT – 2½" and 3" quarter-turn ball valves

PRESSURE-TEMP

Temperature Range: 33°F – 140°F

Maximum Working Pressure: 175psi

APPROVALS

ASSE 1015

UL Classified 28S6

FM approved

CSA B64.5

* = Rated flow ** = UL Rated flow

— Horizontal

— Vertical

- - - - N - Pattern

DIMENSIONS & WEIGHT continued

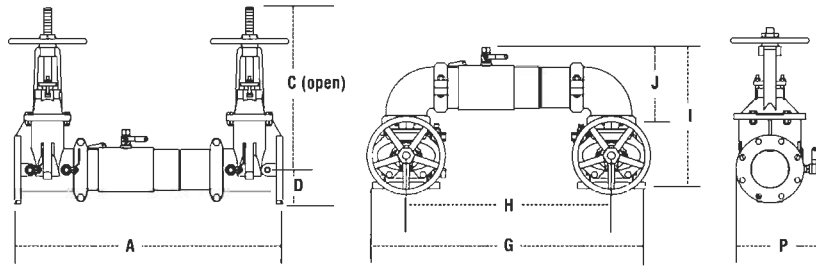

757 / 757N

SIZE (DN)		DIMENSIONS										WEIGHT															
in.	mm	A	C (OSY)	C (NRS)	D	G	H	I	J	P	757NRS	757OSY	757N NRS	757N OSY													
in.	mm	in.	mm	in.	mm	in.	mm	in.	mm	in.	lbs.	kgs.	lbs.	kgs.													
2½	65	31	787	16⅞	416	9⅞	238	3½	89	29⅞	738	22	559	15½	393	8⅜	223	9⅞	234	115	52	125	57	123	56	133	60
3	80	31⅞	805	18⅞	479	10¼	260	3⅞	94	30¼	768	22¼	578	17⅞	435	9⅞	233	10½	267	131	59	145	66	144	65	158	72
4	100	33⅞	856	22¾	578	12⅞	310	4	102	33	838	24	610	18½	470	9⅞	252	11⅞	284	161	73	161	73	184	83	184	83
6	150	44	1118	30⅞	765	16	406	5½	140	44¾	1137	33¾	857	23⅞	589	13⅞	332	15	381	273	124	295	134	314	142	336	152
8	200	50	1270	37¾	959	19⅞	506	6⅞	170	54¼	1375	40⅞	1032	27⅞	697	15⅞	399	17⅞	437	438	199	480	218	513	233	555	252
10	250	57½	1460	45¾	1162	23⅞	605	8⅞	208	66	1676	50	1270	32½	826	17⅞	440	20	508	721	327	781	354	891	404	951	431

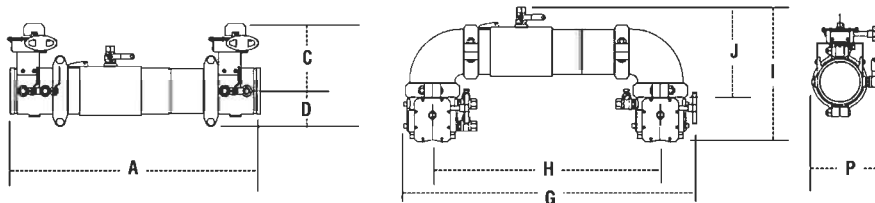

757BFG / 757NBFG

SIZE (DN)		DIMENSIONS										WEIGHT									
in.	mm	A	C	D	G	H	I	J	P	757BFG	757N BFG										
in.	mm	in.	mm	in.	mm	in.	mm	in.	mm	in.	mm	lbs.	kgs.	lbs.	kgs.						
2½	65	28	711	8	203	3½	89	29⅞	759	22	559	14⅞	379	8⅜	223	9	229	56	25	64	29
3	80	28½	724	8⅞	211	3⅞	94	30⅞	779	22¼	578	15⅞	392	9⅞	233	9½	241	54	24	67	30
4	100	29⅞	741	8⅞	227	3⅞	94	31⅞	811	24	610	16¼	412	9⅞	252	10	254	61	28	84	38
6	150	36½	927	10	254	5	127	43⅞	1097	33¾	857	19⅞	500	13⅞	332	10½	267	117	53	157	71
8	200	43	1092	12¼	311	6½	165	51⅞	1297	40⅞	1032	23⅞	592	15⅞	399	14⅞	361	261	118	337	153

MATERIALS

Housing & Sleeve: 304 (Schedule 40) Stainless Steel

Elastomers: EPDM, Silicone and Buna-N

Tri-link Checks: Noryl®, Stainless Steel

Check Discs: Reversible Silicone or EPDM

Test Cocks: Bronze Body Nickel Plated

Pins & Fasteners: 300 Series Stainless Steel

Springs: Stainless Steel

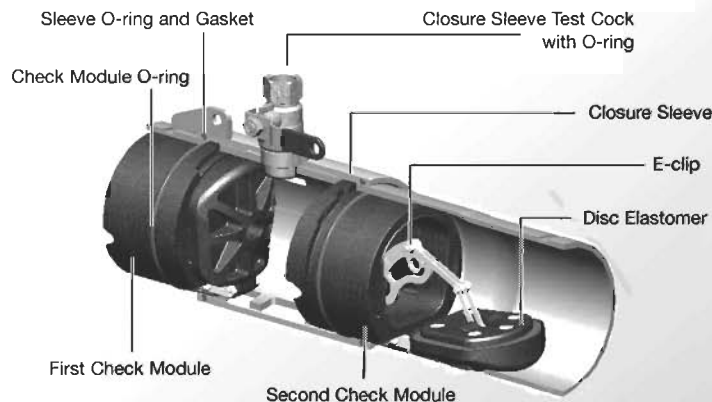

REPAIR KITS

ORDERING NO.	SIZE	MODEL
1st Check Kits		
7018128	2½" - 4"	RK 757/757DCDA CK1
7018131	6"	RK 757/757DCDA CK1
7018134	8"	RK 757/757DCDA CK1
0899200	10"	RK 757/757DCDA CK1
Kit consists of: First check module, Check module O-ring and Disc elastomer		
2nd Check Kits		
7018130	2½" - 4"	RK 757/757DCDA CK2
7018133	6"	RK 757/757DCDA CK2
0899206	8"	RK 757/757DCDA CK2
0899201	10"	RK 757/757DCDA CK2
Kit consists of: Second check module, Check module O-ring and Disc elastomer		
1st or 2nd Check Rubber Parts Kits		
0899202	2½" - 4"	RK 757/757DCDA RC4
0899203	6"	RK 757/757DCDA RC4
0899204	8"	RK 757/757DCDA RC4
0899205	10"	RK 757/757DCDA RC4
Kit consists of: Check module O-ring, Disc elastomer and E-clip		
Check Sleeve Cover Kits		
0899211	2½" - 4"	RK 757/757DCDA C
0899212	6"	RK 757/757DCDA C
0899213	8"	RK 757/757DCDA C
0899214	10"	RK 757/757DCDA C
Kit consists of: Closure sleeve, Sleeve O-ring and Gasket		

American Backflow Specialties

www.americanbackflow.com

(800) 66-BKFLO (619) 527-2525 fax: (619) 527-2527